

# Facility Care Floor Maintenance Procedure Guide



---

## Table of Contents

<b>General Floor Overview</b>	<b>4-5</b>
<b>Resilient Floor Types and Definitions</b>	<b>6</b>
<b>Non- Resilient Floor Types and Definitions</b>	<b>7-8</b>
<b>Sustainable Floor Types and Definitions</b>	<b>9</b>
<b>Chemical Compatibility and Soil Removal</b>	<b>10</b>
<b>Daily Dust Mopping Guide</b>	<b>11</b>
<b>Asphalt Care</b>	<b>12-13</b>
<b>Bamboo Floor Care</b>	<b>14-16</b>
<b>Carpet Care</b>	<b>17-19</b>
<b>Ceramic Tile Care</b>	<b>20-22</b>
<b>Commercial Kitchen Floor Care (Epoxy, PVC, MMA)</b>	<b>23-24</b>
<b>Concrete Care</b>	<b>25-27</b>
<b>Concrete (Stained) Care</b>	<b>28-29</b>
<b>Cork Floor Care</b>	<b>30-32</b>
<b>Engineered Stone (Agglomerate)</b>	<b>33-34</b>
<b>Epoxy (Painted) Floor Care</b>	<b>35-36</b>
<b>Granite Stone Care</b>	<b>37-40</b>
<b>Limestone Stone Care</b>	<b>41-43</b>
<b>Linoleum Care</b>	<b>44-45</b>
<b>Luxury Vinyl Care</b>	<b>46-47</b>
<b>Marble Stone Care</b>	<b>48-51</b>
<b>Quarry Tile Care</b>	<b>52-53</b>

---

<b>Quarry Tile (Kitchen) Care</b>	<b>54-55</b>
<b>Rubber Floor Care</b>	<b>56-58</b>
<b>Rubber (Recycled) Floor Care</b>	<b>59-61</b>
<b>Slate Stone Care</b>	<b>62-63</b>
<b>Static Dissipative (ESD) Floor Care</b>	<b>64-65</b>
<b>Synthetic Sport Floor Care</b>	<b>66-67</b>
<b>Terrazzo (Cement) Care</b>	<b>68-71</b>
<b>Terrazzo (Epoxy) Care</b>	<b>72-74</b>
<b>Terrazzo (Finished) Care</b>	<b>75-76</b>
<b>Travertine (see Limestone pgs 41-43)</b>	
<b>VCT (Vinyl Composite Tile) &amp; Vinyl Care</b>	<b>77-78</b>
<b>Wood Care</b>	<b>79-81</b>
<b>Resilient Floor Finishing Maintenance Guide</b>	<b>82-91</b>
▪ <b>Burnishing</b>	<b>82</b>
▪ <b>Scrub and Recoat</b>	<b>83</b>
▪ <b>Stripping</b>	<b>84-85</b>
▪ <b>Conventional Floor Finishing</b>	<b>86</b>
▪ <b>Phazer Floor Finishing</b>	<b>87</b>
▪ <b>Hybrid Floor Finishing</b>	<b>88-89</b>
▪ <b>Phazer Hybrid Floor Finishing</b>	<b>90-91</b>
<b>Floor and Chemical Selection Chart</b>	<b>92</b>

# GENERAL FLOOR MAINTENANCE OVERVIEW

## MAINTENANCE CYCLES

No matter the floor surface you choose, they all follow the same maintenance cycles. The floor substrate and equipment determines the type of maintenance program you use. It is very important to implement a scheduled maintenance program to maintain the look of the floor and prevent premature costly replacement. Floor care maintenance cycles are broken into four main categories:

### 1. DAILY MAINTENANCE

**Purpose:** To prevent and remove tracked in soil and spills from the floor surface.  
**Frequency:** Daily or more frequently depending on the amount of traffic and soil levels.  
**Procedure:**

#### a) Clean Matting

Good matting procedures are a key component to preventing grit and moisture from entering the facility. Sand and salt will grind into certain floor types, scratching the surface and giving an overall dull appearance. Trapping these particles at the facility entrance is one of the best ways to ensure longevity of a floor. Cleaning the mats on a regular basis to remove the trapped soils is also important as mats have a limit to the amount of dirt they can hold.

#### b) Sweeping, Mopping, Vacuuming

Soil will grind into the floor; therefore, proper soil control is essential. As most soil is dry particles which are able to be removed by sweeping, damp mopping or vacuuming alone, this becomes the critical step prior to all other maintenance programs. Proper equipment and procedures should be used to remove the dry soils from floor and not aerosolize it, causing indoor air quality issues. Use a mild or neutral chemical if needed.

#### c) Spot and Spill Cleaning

Spot cleaning should be performed on spills as soon as they occur. Absorbent white toweling can be used on smaller spills, whereas larger areas may need mopping or even absorbent powders. Removing all residues from the floor will prevent slips and falls and improve the overall appearance. Use a mild or neutral chemical if needed. The difference between a spot and a stain is time.

### 2. INTERIM MAINTENANCE

**Purpose:** To bring back a uniform appearance to the floor with minimal downtime.  
**Frequency:** When high traffic areas show wear that can not be remedied by daily maintenance.  
**Procedure:** Sweep, mop or vacuum floor thoroughly. Use a swing machine, autoscrubber or other equipment to clean the floor surface, blending the traffic lane areas with the rest of the floor. Chemical strength or concentration may increase for this level of cleaning. Air movers can be used to speed drying. Reapply 1 – 2 layers of coatings and burnish, if floor requires.

---

## GENERAL FLOOR MAINTENANCE OVERVIEW - continued

### MAINTENANCE CYCLES

#### 3. RESTORATIVE MAINTENANCE

**Purpose:** To remove deeply embedded soil when other methods are no longer sufficient.  
**Frequency:** Dependent on when the floor appearance is no longer acceptable.  
**Procedure:** Sweep, mop or vacuum floor thoroughly. Pre-treat the heavily soiled areas, strip/sand coatings from the floor substrate or grind the floor. Thoroughly clean the floor with appropriate equipment and chemicals. Air movers may be used to speed drying. Polish, seal or reapply multiple layers of coatings and burnish, if floor requires.

#### 4. ADDITIONAL SOLUTIONS

Ancillary offerings are available as additions to the standard maintenance cycle, and are applied before or after the cleaning is complete. Topical solutions can be applied for extra stain resistance on some surfaces. In a few instances, ancillary solutions are necessary to bind coatings to the floor substrate or to prevent water penetration. Other materials can impart extra shine or aid in slip resistance. These solutions can make the daily cleaning process easier and prolong the need for more intensive cleaning steps. There are also solutions to add to the recovery tanks of equipment to improve run efficiency.

### GENERAL COMMENTS

1. Each level of maintenance requires increasingly more labor. Time invested at each lower level will increase the time interval before an increasing level of maintenance is required. Using this approach will minimize product usage and maximize labor savings.
2. Spot removal is best accomplished on a fresh soil. The easiest method of spot identification is to ask. The location, shape, smell and feel of spots are also good indicators of their origin. Not all spots are caused by soil or stains. Not all spots can be removed.

## FLOOR TYPES AND DEFINITIONS

### RESILIENT FLOORS

Resilient floors refer to any non-textile material which is firm but can “give” under pressure, returning to the original surface profile when the weight is removed. It comes in tile, sheet and roll types. Resilient floors are used in a variety of commercial settings due to its ease of cleaning, moisture resistance and durability. Commercial applications include education (easy maintenance), healthcare (disinfection capabilities) and retail (design options).

**VINYL COMPOSITION TILE (VCT)** – Made from 1/8” thick polyvinyl chloride (PVC) and limestone filler. Tiles are cut to 12” squares. Once in place, the floor can be repeatedly finished with floor finish and buffing. Floors are not chemically sensitive, although the finish may be. It has long been the most popular hard floor surface in the U.S. due to its low cost, durability and ease of maintenance.

**VINYL (SHEET)** - Made from polyvinyl chloride (PVC) and plasticizer. Mostly sheets or rolls, but some 12” tiles. Can be maintained with conventional floor finishes, but is less porous than VCT and may need a sealer to prevent adhesion issues. Floors are not chemically sensitive, although the finish may be.

**VINYL ASBESTOS** – Made from polyvinyl chloride (PVC) and asbestos. Asbestos tiles are commonly 9” square. Tiles should always be kept flooded when stripping so as not to expose asbestos to the air. Maintain with conventional floor finishes. Floors are not chemically sensitive, although the finish may be.

**LUXURY VINYL** – Vinyl material that has the look of wood, stone or ceramics. Comes in tiles and planks. Supplied with a factory wear layer and may need a sealer (for adhesion) if conventional finish is applied. Minimal water and neutral products should be used for cleaning.

**PVC** - Made from polyvinyl chloride (PVC) and plasticizer. Mostly sheets or rolls, Found in commercial kitchens, aquatic areas, hospitals and animal care facilities. Floors are not chemically sensitive and require no coatings. Resists stains and odors.

**LINOLEUM** – Made from solidified linseed oil and flexible backing; may contain pigments. Sizes vary. Need a protective finish to prevent harm to the tile. Conventional finishes are acceptable, but aggressive cleaners and strippers (high alkalinity) will damage the linoleum. Use linoleum safe chemistries.

**SYNTHETIC SPORT FLOORS (PERMANENT)** – Rubber base floors with a polyurethane wear layer or topcoat. The rubber/polyurethane system is poured in place and seamless. The surface has little harsh chemical resistance and care should follow manufacturer’s recommendations.

**RUBBER** – Natural or synthetic rubber in varying concentrations; may contain pigments. Available in rolls and tiles. Similar to vinyl in quality. Sealing is not recommended on natural (vulcanized) rubber; the natural migrating waxes can be buffed. If the recycled (synthetic) rubber has a factory finish, it can be maintained by buffing. Minimal water should be used for cleaning unfinished surfaces. Not solvent or oil cleaner resistant.

**STATIC CONDUCTIVE FLOORS (ESD)** – Specially formulated floors that include carbon or other similar conductive material, available in vinyl, rubber or linoleum. Available in sheets or tiles. Usually found in computer rooms, hospitals and healthcare settings. Special conductive finishes and cleaners are required for maintenance. Follow manufacturer’s recommendations. ***No Ecolab offerings at this time.***

**CORK** – Natural floor from tree bark, compressed into tiles, rolls and planks. May have a fiberboard core. Acrylic-urethane, lacquer or aluminum oxide coated from the manufacturer, which should be refreshed with wear. Avoid ammonia or abrasive products. Use minimal water and neutral products.

**ASPHALT** – Made from asphalt, synthetic resins, mineral fillers and, in some cases, asbestos. Tiles are formed under heat and pressure to 9” and 12” sizes. It is moisture resistant, but can crack when subjected to solvents or high alkalinity. A sealer may be needed on new installations. Scrub and recoat with a mild alkaline cleaner and use conventional finishes.

---

## NON-RESILIENT FLOOR OPTIONS

Non-resilient floors are comprised of two categories, hard and soft. Hard floors contain wood, laminate, concrete, ceramic tile and stone; soft floors are carpet and rugs. The manufactured sizes and styles are endless. Non-resilient floors are used in commercial settings for ease of maintenance, longevity and beauty. Commercial applications include restaurants (slip resistance), hospitality (aesthetics) and industrial settings (durability).

**WOOD** – Natural floor made from domestic and imported hardwoods, like oak, maple, birch, teak and mahogany. The wood can be strip, plank, parquet, manufactured solid, engineered, factory finished (aluminum oxide), unfinished and acrylic impregnated. Only coatings designed for wood are recommended. Floors are maintained, as needed, by sanding and acrylic/urethane finishes. Never use resilient floor finishes or resilient strippers on wood. Minimize water contact and use neutral cleaners only.

**LAMINATE** – A synthetic floor (usually melamine resin) that is made to look like natural materials - wood or stone. The material can be combined with natural or recycled ingredients and is covered with a coating that includes aluminum oxide. Can be planks or tiles, and the floor is monolithic – interlocking without glue or adhesive. It does not need to be waxed, oiled or finished. The material is resistant to scratching, but matting and furniture protectors should be used. Minimize water contact and some cleaners may leave a haze. Follow manufacturer's maintenance procedures.

**BAMBOO** – A natural floor made from grass. The bamboo can be manufactured with different grains (horizontal or vertical) and different colors (natural or carbonized), in solid, engineered and strand planks. Also can be interlocking for installation. Most are shipped with a factory topcoat or wear layer. Minimize water contact and use neutral cleaners only.

**CONCRETE** – Made by mixing cement (Portland), water, aggregates and admixtures. The material can be poured to the correct thickness and allowed to dry, or installed as pavers, bricks or slabs. Color can be added on the surface (dry shake) or integrally (acid-stain). Concrete is very porous and must be sealed to prevent surface staining and allow for easier cleaning. Some sealers will allow adhesion of finishes for burnishing. Concrete is very durable, but acids can degrade the cement.

**EPOXY COATINGS** – An epoxy, methyl methacrylate (MMA) or polyurethane coating system usually applied over concrete. Can be water-based, solvent-based or 100% epoxy. Application is by roller or trowel and may need a primer over porous or damaged concrete. Silicon carbide can be added for slip resistance. Good abrasion and chemical resistance, some even for high acid, high alkaline and solvents. Check manufacturer chemical ratings.

**CERAMIC TILE** – Inorganic, non-metallic materials (usually clay) formed under high temperature. The material may be painted and glazed. Sizes vary from small mosaic (1") to much larger. The spaces between the tiles are filled with sanded or unsanded grout. Although the tiles themselves are highly abrasive, chemical and water resistant, the grout itself is not and may need to be sealed. Brush scrubbing and wet vacuuming are needed for periodic cleaning of the grout.

**PORCELAIN TILE** – A type of ceramic that is fired under extremely high temperatures, making it harder (more dense) than other ceramics and natural stones. Tile sizes vary, and come glazed, unglazed, antiqued and honed. It has low absorption and will not stain. The material is very low maintenance and is not abrasion or chemical sensitive. Brush scrubbing and wet vacuuming are needed for periodic cleaning of the grout.

**QUARRY TILE** – An extruded material made from clay or shale. Traditional tile sizes are 6" and 8". Tiles are unglazed and are very porous. The surface is rough, and combined with good absorption, makes these ideal for kitchen floors. Excellent chemical resistance and easy to maintain. Brush scrubbing and wet vacuuming are needed for periodic cleaning of the grout.



**GRANITE** – Igneous rock formed from magma and contains feldspar, quartz or mica. The material is harder than marble and can be cut to shape, usually in tiles or slabs. Granite is very wear resistant and is maintained by grinding and polishing. Adhesion of floor finishes is problematic for highly polished granites. Not acid sensitive. Impregnation will help protect granite from liquid stains.

**SLATE** – Metamorphic rock composed mainly of clay and shale. The top edge is cleaved and therefore irregular by design. It is cut to shape in tiles or slabs. Slate is porous and can hold floor finish, which should be maintained with a contoured burnishing pad so as not to harm the top edge. Unfinished slate should be sealed/impregnated to prevent staining. The material is not harmed by harsh chemicals.

**MARBLE** – Metamorphic rock comprised of hardened limestone (calcite – the crystalline form of calcium carbonate). The material is soft and can be cut to shape, usually in tiles or slabs. It can be scratched easily but is maintained by grinding and polishing the stone. Adhesion of floor finishes is problematic for highly polished marbles. Clean with neutral, marble-safe products – acid will etch, alkalines will erode, and water conditioners will dull marble. Impregnation will help protect marble from liquid stains.

**LIMESTONE (TRAVERTINE)** – Sedimentary rock comprised of mostly calcite (calcium carbonate). The tiles and slabs are extremely soft and can abrade easily. It is porous and needs to be sealed/impregnated or will hold a finish. Limestone is acid sensitive and should be cleaned with neutral marble-safe or slightly alkaline cleaners; acid will etch, strong alkalines will erode, and water conditioners will dull limestone. Impregnation will help protect limestone from liquid stains.

**TERRAZZO (CEMENT)** – Tri-layered concrete with pigmented marble chips intermixed in the top layer. The material is usually poured into place with metal strips separating the sections, but can be produced in tiles or slabs. Can be polished by procedures similar to natural stone. Needs a sealer before applying finish to prevent excess finish absorption into the porous concrete. Clean with neutral or slightly alkaline cleaners. Not acid safe.

**TERRAZZO (EPOXY)** – A polymer binder – usually epoxy – with marble aggregate, glass or other material chips embedded within the floor. Can be poured into place or in tiles. Greater range of colors than cement based terrazzo and also less porous. Can be maintained by polishing techniques or with floor finish. A sealer is needed to prevent floor finish adhesion issues. Epoxy is fairly chemical resistant, but the marble chips are acid sensitive.

**ENGINEERED STONE (AGGLOMERATE)** – Man-made from > 90% natural stone materials (marble, granite, quartz) and resins compacted under high heat and pressure. The top surface is then polished by diamond grinding. Can be tiles, slabs, sheets or cut to desired dimensions. The resulting material is extremely hard and resistant to scratches and water absorption. Does not need a sealer, impregnator or finish. Impervious to most chemicals. Follow manufacturer's care instructions. (*See Cambria, Silestone*)

**SYNTHETIC SPORT FLOOR (MODULAR)** - A polypropylene copolymer floor system that is not permanently laid in place. The modular floor consists of interlocking tiles and can be placed over any subfloor material. Because the floor is not sealed together, care should be taken to prevent excess moisture from the cleaning process causing damage to the subfloor. The surface has little harsh chemical resistance and care should follow manufacturer's recommendations.

**SYNTHETIC SPORT FLOOR (PERMANENT)** – See **RUBBER** in Resilient Floor section.

**CARPET** - A textile that is woven or glued onto a backing material. The fibers can be natural (cotton, wool, grass), synthetic (nylon, polypropylene, polyester), a blend of both types or recycled. Most new carpets have a fluorochemical coating to repel stains. Maintenance consists of vacuuming and cleaning with manufacturer approved chemicals. Do not use cationic chemicals (softeners), silicones or high pH (>10) cleaners.



---

## SUSTAINABLE FLOOR OPTIONS

The green movement has seen an increase in interest of sustainable floor options. The life cycle of these floors – manufacturing, transportation, installation, daily use and disposal - is taken into consideration for sustainability. Recycled and recyclable content is important and VOC emission from materials or installation products should be extremely low to help reduce the floors environmental footprint. Sustainable floor options may support LEED certification and other green building initiatives.

**LINOLEUM** – Resilient floor that is made from all natural materials, including linseed oil, pine rosin, cork, wood flour and mineral fillers. It is bonded to a jute or burlap backing. Most materials produced today are homogeneous and marbleized, not surface printed as in the past. For care, see the Resilient Floor section.

**CORK** – Resilient floor that is made from the bark of the cork oak tree, which can regenerate itself after harvesting. Some floors are also a recycled byproduct of the cork wine stopper manufacturing process. Finish coat should be organic solvent free and meet VOC criteria for this category. For care, see Non-Resilient Floor section.

**WOOD** – Non-resilient floor that is made from trees like oak, maple, birch, teak and mahogany. The biodegradable material can be rejuvenated with sanding and refinishing, instead of replacement. Reclaimed timber from barns, factories and river beds are being recycled into unique floor options. Manufacturers are offering VOC compliant materials for installation. For care, see the Non-Resilient Floor section.

**BAMBOO** – Non-resilient floor that is made from bamboo, which is a grass (Moso species). The bamboo is cut into strips and planed – sold as solid wood or veneered. It is a harder wood than either maple or white oak. The manufacturer installed urethane topcoat can be maintained similar to other wood floors. For care, see the Non-Resilient Floor (Wood) section.

**CARPET** – Non-resilient floor that is made from refurbished, reused or recycled materials, carpets are becoming a more sustainable option. Limits are set on the VOC emissions from the carpet, adhesives and cushions. Government and industry initiatives promote recycling carpet to prevent more from reaching landfills. For care, see the Non-Resilient Floor section.

**RECYCLED RUBBER** – Resilient floor that is made from post-consumer material (rubber tires) usually salvaged from landfills. The manufacturing process is low energy and low waste. Follow manufacturer's care instructions, but most can be maintained like any other resilient floor. See the Resilient Floors section.

**RECYCLED VINYL** – Resilient floors that include recycled materials from post-industrial vinyl from cars, billboards, carpet backings and roofing. The resulting vinyl comes in sheet and tile forms. Follow manufacturer's care instructions or see the Resilient Floor section.

## CHEMICAL COMPATIBILITY AND SOIL REMOVAL

### CHEMICAL COMPATIBILITY

Some floor substrates can be easily damaged or etched by chemicals. Everyday materials such as cola, toothpaste, baking soda, nail polish remover and gasoline can also cause damage if spilled on some floors. Topical treatments can be applied to try and prevent or delay chemicals from contacting the floor substrates, but prevention of spills and proper cleaning techniques should always be employed. Light damage may be fixed with restoration methods, but those become more costly as the damage level increases.

#### Acid Sensitive

Concrete  
Terrazzo (Concrete) – both concrete and marble chips  
Terrazzo (Epoxy) – marble chips  
Marble  
Limestone  
Wood

#### Alkaline Sensitive

Linoleum  
Asphalt  
Floor Finishes  
Marble  
Wood

#### Solvent Sensitive

Rubber  
Linoleum  
Synthetic Sports Floors (Poured)  
Asphalt  
Wood

#### Water Sensitive

Wood  
Linoleum  
Cork

#### Abrasive Sensitive

Marble  
Wood  
Rubber  
Synthetic Sports Floors (Modular)

### SOIL REMOVAL

A soil can be any foreign matter on the floor. Dry particulate can be easily removed by sweeping or vacuuming; wet soils that contain grease or oil may need surfactants or alkalinity to be removed. Knowing what product is most effective on which soil will make cleaning easier – keeping in mind that the cleaner also needs to be compatible with the floor substrate. In general, a neutral cleaner is the safest choice.

**General Soils** – Dirt, sand and dust are dry particles that can be abrasive to certain floor surfaces or finishes. Sweeping or vacuuming will prevent this soil from scratching softer stones, grinding into carpet fibers and imbedding in floor finish. Daily removal of this soil type prolongs the time before interim cleaning is needed.

**Greasy Soils** – Certain foods, like butter or salad dressings, can leave a slippery film on restaurant floors, increasing the potential for slips and falls. Neutral cleaners can be effective, but the animal or vegetable based fats are emulsified by an alkaline detergent for easier removal.

**Polymerized Grease Soils** – Once kitchen greases have been submitted to high temperatures from deep fryers or ovens, the structure of the grease changes, making it more difficult to remove. Alkalinity will have some effect, but is more effective when combined with solvents. Some products are formulated with thickeners to cling to vertical surfaces.

**Petroleum Soils** – Not created from animal or plant sources. Soils are scuff marks from shoes, parking lot tar, crayons, etc. Solvents are used to break down the petroleum hydrocarbons into smaller droplets, making them easier to hold in suspension for removal.

**Hard Water/Mineral Soils** – Comprised of high mineral content, mostly calcium and magnesium, hard water can interfere with a cleaning product's ability to remove soil. The minerals can also be left behind and will precipitate on surfaces. Acidic cleaners will remove mineral soils, but care should be taken so as not to etch softer stone surfaces.

---

## DAILY DUST MOPPING GUIDE

The best way to avoid costly maintenance or material replacement is to prevent the soil from reaching the floor surface in the first place. Proper walk-off matting, *six to twelve feet in length*, placed at entrances and doorways will help to “scour” shoes and hold the dirt before it reaches the floor. Once the mats reach their equilibrium they will release the soil back to the floor; daily (or more frequent) vacuuming is necessary to prevent this. If the dirt does reach the floor, dust mopping is necessary to avoid damaging the floor surface. Foot traffic has the equivalent of 400 grit sandpaper, which can scratch softer surfaces or embed the dirt in finishes.

### Clean Matting

1. Dump sand and grit from exterior type walk-off mats.
2. Sweep heavy soil into dust pan for disposal.
3. Thoroughly vacuum all interior carpeted type walk-off mats.
4. Thoroughly clean and store all equipment after use.

### Dust Mopping

1. Treat mop with dust mop treatment according to label directions.
2. Dust mop floor. Run the dust mop over the entire floor surface. Keep the dust mop on the floor surface. Do not shake the mop, as this will cause dust particles to become airborne.
3. Use broom or counter brush to sweep accumulated soil from the floor surface into dust pan for disposal.
4. After dust mop has been used, shake mop vigorously outdoors or into large trash container to release the accumulated dust.
5. Replace the dust mop head with a clean one when it becomes soiled. Soiled dust mops should be laundered.
6. Use scraper to remove any gum, tape, or stickers from floor surface.
7. Thoroughly clean and store all equipment after use.

# ASPHALT CARE: DAILY MAINTENANCE WITH AUTOMATIC SCRUBBER AND MOP/BUCKET

## EQUIPMENT REQUIRED

Dust mop
Damp mop (cotton or synthetic)
Mop bucket with wringer
Auto scrubber
Red pads
Wet floor signs
Proper safety equipment (goggles, gloves and appropriate footwear)

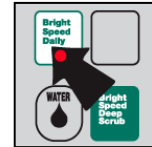
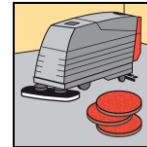

## PRODUCT REQUIRED

Product	Dilution Rate
Quik Fill 35 MAXX Dual Action Floor Cleaner	$\frac{1}{8}$ - $\frac{1}{4}$ oz/gal
QC 35 MAXX Dual Action Floor Cleaner	$\frac{1}{4}$ - $\frac{1}{2}$ oz/gal
Quik Fill 34 Neutral Floor Cleaner	$\frac{1}{2}$ -2 oz/gal
QC 34 High Performance UC Neutral Floor Cleaner	$\frac{1}{4}$ -1 oz/gal
FACILIPRO™ Alkaline Floor Cleaner	$\frac{1}{8}$ - $\frac{1}{4}$ oz/gal
FACILIPRO™ Neutral Floor Cleaner	$\frac{1}{2}$ -2 oz/gal
FACILIPRO™ Concentrated Alkaline Floor Cleaner	$\frac{1}{4}$ - $\frac{1}{2}$ oz/gal
FACILIPRO™ Concentrated Neutral Floor Cleaner	$\frac{1}{4}$ -1 oz/gal

## PROCEDURE

### Automatic Scrubber

1. Position wet floor signs. Put on proper safety equipment.
2. Use broom to sweep accumulated soil from the floor surface into dust pan for disposal. **Do not use oil based dust mop sweeping solutions as they will soften the tiles.**
3. Mix cleaning solution in the auto scrubber and mop bucket using appropriate dilution rate per gallon of water.
4. Position the red pad onto the auto scrubber.
5. Using the auto scrubber, apply the cleaning solution, scrub and pick up residue.
6. Mop the corners and edges manually and remove any excess solution not recovered by the auto scrubber.
7. Thoroughly clean and store all equipment and pads after use.
8. Remove wet floor signs.
9. Burnish as needed (see Resilient Floor Finishing Maintenance Guide – Page 82).

---

## ASPHALT CARE: DAILY MAINTENANCE WITH AUTOMATIC SCRUBBER AND MOP/BUCKET (CON'T)

### Mop and Bucket

1. Position wet floor signs. Put on proper safety equipment.
2. Use broom to sweep accumulated soil from the floor surface into dust pan for disposal. **Do not use oil based dust mop sweeping solutions as they will soften the tiles.**
3. Mix cleaning solution in the mop bucket using appropriate dilution rate per gallon of water.
4. Use a cotton or synthetic mop with cleaning solution.
5. Partially wring out mop and apply cleaning solution to approximately 10' by 10' area of floor surface. Thoroughly wring out mop in bucket and pick up excess solution from the 10' by 10' area.
6. Repeat step 4 until the entire floor area has been cleaned.
7. Thoroughly clean and store all equipment after use.
8. Remove wet floor signs.
9. Burnish as needed (see Resilient Floor Finishing Maintenance Guide – Page 82).

***Special Considerations – If disinfection of finished floors is required, use Hybrid finishes to prevent stickiness from quats.***

## ASPHALT CARE: INTERIM MAINTENANCE

***See Resilient Floor Finishing- Maintenance Guide Page 83***

***Special Considerations – To maintain alcohol sanitizer resistance, spray buff or maintainer products should not be used on Hybrid finishes.***

## ASPHALT CARE: RESTORATIVE MAINTENANCE

***See Resilient Floor Finishing - Maintenance Guide Pages 84-91***

***Special Considerations – Use strippers with pH < 12, like Ecolab's Linoleum Floor Stripper. If using Hybrid finishes, only non-chemical removal methods (SPP) can be used.***

# BAMBOO CARE: DAILY MAINTENANCE WITH DUST MOPPING

## EQUIPMENT REQUIRED

Walk off mats
Treated dust mop
Cotton Towels
Proper safety equipment (goggles, gloves and appropriate footwear)

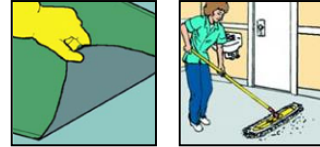

## PRODUCT REQUIRED

Product	Dilution Rate
Huntolene® Dust Mop Treatment	RTU
Full Court Wood Floor Cleaner	2-4 oz/gal

## PROCEDURE

### Dust Mopping

1. Pick up and dispose of debris. Remove gum from floor.
2. Use Huntolene® treated broom to sweep accumulated soil from the floor surface into dust pan for disposal.
3. Clean up spills with Full Court Cleaner and remove any moisture on the floor. Place "Wet Floor" signs until floor dries.
4. Vacuum floor mats.



# BAMBOO CARE: INTERIM MAINTENANCE WITH DAMP MOPPING

## EQUIPMENT REQUIRED

Walk off mats
Dust mop
Mop and bucket with wringer
Proper safety equipment (goggles, gloves and appropriate footwear)

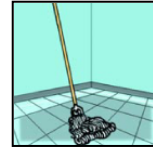

## PRODUCT REQUIRED

Product	Dilution Rate
Huntolene® Dust Mop Treatment	RTU
Full Court Wood Floor Cleaner	2-4 oz/gal

## PROCEDURE

1. Repeat daily maintenance.
2. Place "Wet Floor" signs until floor dries.
3. Damp mop the floor with Full Court Cleaner.

# BAMBOO CARE: RESTORATIVE MAINTENANCE WITH SCREENING AND REFINISHING

## EQUIPMENT REQUIRED

Low speed swing machine
120 mesh screen or maroon pad
Wet vac or floor vac with wand
Push broom and mop bucket with wringer
White towels
T-bar (weighted for oil based finishes)
Proper safety equipment (goggles, gloves and appropriate footwear)

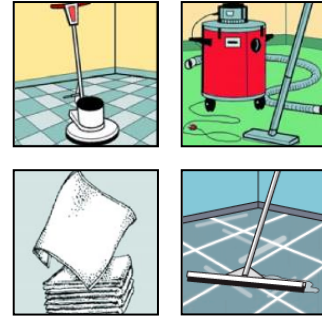

## PRODUCT REQUIRED

Product	Dilution Rate
Front Court (water based finish)	RTU
Classic 50 Ultra™ (oil based finish)	RTU

## PROCEDURE

1. Position wet floor signs. Put on proper safety equipment.
2. Place 120 mesh screen or maroon pad onto swing machine.
3. Lightly screen the floor in the direction of the boards. This should be a quick screening to rough up the surface so the next coat of finish can adhere.
4. Dry vacuum the entire floor in the direction of the boards.
5. Tack the floor - soak white towels in a mop bucket, wring them out as much as possible. Drape the damp towel over the head of a push broom and push the broom across the floor in the direction of the boards with either water or a solvent to remove fine dust. If you are going to apply a water based finish, tack with water. If you are going to use an oil based finish, tack with a solvent.
6. Repeat step 5 until all dust is removed from the floor. If any dust is removed after running your hand over the floor repeat step 5.
7. Allow floor to dry before applying finish.
8. Finish application - place synthetic head onto T-bar applicator. If applying a water based finish, use a non-weighted T-bar. If applying an oil based finish, use a weighted T-bar.
9. Pour finish onto floor in a line running with the boards down one side of the room. Using the T-bar applicator, spread the initial line of product up to the wall.
10. Starting at one end of the room, spread the product in the direction of the boards, making sure to angle the head of the applicator towards yourself so that any excess finish is pushed onto the next area to be coated. When you get to the end of the room turn the applicator towards yourself and pull excess finish onto the next area to be coated.
11. Place the applicator head on the floor and push down to remove any excess finish.
12. Repeat steps 9 – 11 until the room is coated. On the last section of floor, spread product side to side with applicator to smooth it out, and exit the room.
13. Thoroughly clean and store all equipment after use.

**Special Considerations: Aluminum oxide coatings can have adhesions issues. Ecolab product recommendation for urethane finish – Front Court**

## CARPET CARE: DAILY MAINTENANCE

### EQUIPMENT REQUIRED

Vacuum or pile lifter
White towels
Spotting brush
Bone scrapper or spoon
Proper safety equipment (goggles, gloves)

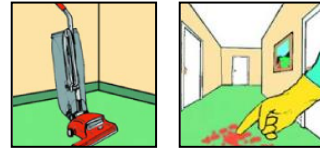

### PRODUCTS REQUIRED

Product	Dilution Rate
Revitalize™ Miracle Spotter	RTU
FACILIPRO™ Miracle Spotter	RTU

### PROCEDURE

#### Vacuum

1. Select the equipment that is best suited for the job and size requirements. Consider the vacuum's filtration capabilities as well.
2. Remove major obstacles (furniture, plants, signage, etc.).
3. Make a steady pass across the carpet (one pass is straight forward and straight back), making sure the brush action is against the carpet pile whenever possible.
4. Overlap the next pass by two to three inches to ensure full coverage.
5. If the carpet contains excess soil, a second pass at 90° to the first pass can be made.
6. The bag or canister should be emptied when 2/3 full to maintain proper air flow.
7. Thoroughly clean and store all equipment after use.

#### Spotting

1. Remove excess liquid material and scrape any solid soils with a bone scraper or spoon.
2. Apply the appropriate spotter to the spot and work inward to avoid spreading the spot.
3. Cover the spot with a clean, white towel and tamp the area with the carpet spotter brush.
4. Avoid rubbing stains or agitating the carpet with the brush in a circular motion, as that drives the stain downward. Keep turning the toweling as this will allow the soil to transfer from the carpet to the cloth.
5. Repeat steps 2 thru 4 if necessary. Some spots may take more than one application.
6. For set stains: place white toweling over the stained area. Using a steam iron at medium setting, place the steam iron on the toweling for 45 seconds.
7. Follow with a water rinse if required.
8. For stains that reappear, use a hair dryer to dry the area and prevent wicking.
9. Put away equipment and supplies.

***Other spotters for more specific soil types are available. See the Carpet Care Maintenance Procedure Guide for more info.***

# CARPET CARE: INTERIM MAINTENANCE WITH ENCAPSULATION

## EQUIPMENT REQUIRED

Vacuum
Pump-up sprayer
Encapsulation equipment
Wet floor signs
Proper safety equipment (gloves)



## PRODUCTS REQUIRED

Product	Dilution Rate
Revitalize™ Encapsulation Carpet Cleaner	8 oz/gal
FACILIPRO™ Encapsulation Carpet Cleaner	8 oz/gal

## PROCEDURE

1. Remove spots using the appropriate Revitalize™ spotter.
2. Thoroughly vacuum the area.
3. Prepare Revitalize™ Encapsulation Carpet Cleaner solution by following mixing instructions on the product label.
4. Place the solution into a pump-up sprayer and apply to the area at a rate of 600-1000 ft<sup>2</sup>/gal. Do not overwet the carpet.
5. Allow 5 – 10 minutes for dwell time.
6. Work cleaner into carpet with the encapsulation equipment, overlapping each pass.
7. Allow area to dry, approximately 30 – 60 minutes, before opening to traffic.
8. Remove encapsulated soil at next scheduled vacuuming.
9. Put away equipment and supplies.

***Other methods for interim cleaning are available. See the Carpet Care Maintenance Procedure Guide for more info.***

# CARPET CARE: RESTORATIVE MAINTENANCE WITH EXTRACTION

## EQUIPMENT REQUIRED

Vacuum
Pump-up sprayer
Extraction machine
Air mover or fans
Wet floor signs
Proper safety equipment (gloves and appropriate footwear)



## PRODUCTS REQUIRED

Product	Dilution Rate
Revitalize™ Carpet and Upholstery Prespray Cleaner	4-8 oz/gal
Revitalize™ Carpet and Upholstery Extraction Cleaner	1-2 oz/gal
Revitalize™ Perfusion Carpet and Upholstery Cleaner	1-2 oz/gal
FACILIPRO™ Carpet & Upholstery Prespray Cleaner	4-8 oz/gal
FACILIPRO™ Carpet & Upholstery Extraction Cleaner	1-2 oz/gal
FACILIPRO™ Carpet & Upholstery 3 in 1 Cleaner	1-2 oz/gal

## PROCEDURE

1. Place wet floor signs.
2. Remove spots and stains, using the appropriate Revitalize™ Spotter.
3. Vacuum the area thoroughly.
4. If necessary, prepare Carpet & Upholstery Prespray Cleaner or Perfusion / 3 in 1 Cleaner solution by following mixing directions on the product label. Place the Prespray or Perfusion solution into a pump up sprayer and spray the heavily soiled area as required.
5. Mix Carpet & Upholstery Extraction Cleaner or Perfusion/ 3 in 1 Carpet & Upholstery Cleaner solution according to the directions on the product label and pour into extraction machine. If a prespray was used, the extraction machine can be filled with fresh water.
6. Extract the area. Move in a straight line, overlapping each pass. Be careful not to over wet the carpet. Add Revitalize™ Defoamer to the recovery tank of the extraction machine, if needed.
7. To shorten drying times, make a second pass over the area with the vacuum on and extract as much moisture as possible.
8. Use fans to speed up drying.
9. When dry, vacuum area thoroughly.
10. Put away equipment and supplies.

***Other methods for restorative cleaning are available. See the Carpet Care Maintenance Procedure Guide for more info.***

# CERAMIC TILE CARE: DAILY MAINTENANCE WITH AUTOMATIC SCRUBBER OR MOP/BUCKET

## EQUIPMENT REQUIRED

Damp mop (cotton or synthetic)
Mop bucket with wringer
Deck brush
Auto scrubber
Red pads or brush
Wet floor signs
Proper safety equipment (goggles, gloves and appropriate footwear)

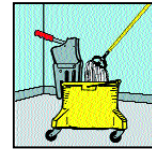
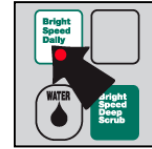
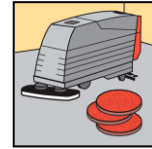

## PRODUCT REQUIRED

Product	Dilution Rate
Quik Fill 35 MAXX Dual Action Floor Cleaner	$\frac{1}{8}$ - $\frac{1}{4}$ oz/gal
QC 35 MAXX Dual Action Floor Cleaner	$\frac{1}{4}$ - $\frac{1}{2}$ oz/gal
Quik Fill 34 Neutral Floor Cleaner	$\frac{1}{2}$ -2 oz/gal
QC 34 High Performance UC Neutral Floor Cleaner	$\frac{1}{4}$ -1 oz/gal
FACILIPRO™ Alkaline Floor Cleaner	$\frac{1}{8}$ - $\frac{1}{4}$ oz/gal
FACILIPRO™ Neutral Floor Cleaner	$\frac{1}{2}$ -2 oz/gal
FACILIPRO™ Concentrated Alkaline Floor Cleaner	$\frac{1}{4}$ - $\frac{1}{2}$ oz/gal
FACILIPRO™ Concentrated Neutral Floor Cleaner	$\frac{1}{4}$ -1 oz/gal

## PROCEDURE

### Automatic Scrubber

1. Position wet floor signs. Put on proper safety equipment.
2. Use broom to sweep accumulated soil from the floor surface into dust pan for disposal.
3. Mix cleaning solution in the auto scrubber and mop bucket using appropriate dilution rate per gallon of water.
4. Position the red pad or brush onto the auto scrubber.
5. Using the auto scrubber, apply the cleaning solution, scrub and pick up residue.
6. Mop the corners and edges manually and remove any excess solution.
7. Thoroughly clean and store all equipment and pads after use.
8. Remove wet floor signs.

### Mop and Bucket

1. Position wet floor signs. Put on proper safety equipment.
2. Use broom to sweep accumulated soil from the floor surface into dust pan for disposal.
3. Mix cleaning solution in the mop bucket using appropriate dilution rate per gallon of water.
4. Use a cotton or synthetic mop with cleaning solution.
5. Partially wring out mop and apply cleaning solution to approximately 10' by 10' area of floor surface. Thoroughly wring out mop in bucket and pick up excess solution.
6. Deck brush grout lines, if necessary.
7. Repeat steps 4-5 until the entire floor area has been cleaned.
8. Thoroughly clean and store all equipment after use.
9. Remove wet floor signs.



# CERAMIC TILE CARE: INTERIM MAINTENANCE WITH GROUT IMPREGNATION

## EQUIPMENT REQUIRED

Damp mop (cotton or synthetic)
Mop bucket or autoscrubber with red pad
Deck brush
Low speed machine with brush
Wet vac
Wet floor signs
Proper safety equipment (goggles, gloves and appropriate footwear)

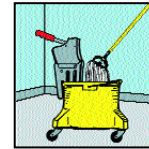
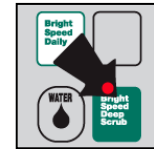
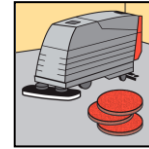

## PRODUCT REQUIRED

Product	Dilution Rate
Pinnacle® Intensive Tile Cleaner	12-64 oz/gal
Pinnacle® Grout Line Impregnator	RTU
StoneMedic® CIC Ceramic Intensive Tile Cleaner	12-64 oz/gal
StoneMedic® CGI Ceramic Grout Impregnator	RTU

## PROCEDURE

### Interim Cleaning

1. Position wet floor signs. Put on proper safety equipment.
2. Apply Intensive Tile Cleaner to the floor at the proper dilution with lukewarm water using a mop and bucket or autoscrubber.
3. Initial quick agitation (low speed machine/autoscrubber with brush or deck brush).
4. Allow to dwell for 6 to 10 minutes.
5. Scrub well into grout lines (low speed machine/autoscrubber with brush or deck brush).
6. Remove solution with wet vacuum/autoscrubber or mop and bucket.
7. Rinse with a fresh water solution.
8. Thoroughly clean and store all equipment and pads after use.
9. Remove wet floor signs.

### Grout Line Impregnation

1. Position wet floor signs. Put on proper safety equipment.
2. Apply Grout Impregnator to grout lines with roller or sprayer.
3. Work product into grout lines with deck brush or low speed machine and a white pad.
4. Let sit 10 minutes to absorb into grout.
5. Squeegee excess product from tiles and grout lines, crossing the tiles on a diagonal.
6. Tack up excess with a cotton towel.
7. Allow 6 – 8 hours to dry thoroughly before allowing foot traffic.
8. Thoroughly clean and store all equipment after use.
9. Remove wet floor signs.

# CERAMIC TILE CARE: RESTORATIVE MAINTENANCE WITH CERAMIC TILE POLISH

## EQUIPMENT REQUIRED

Synthetic, looped end mop
Mighty Max Floor Machine (fully loaded)
Mop bucket w/wringer
CTP-1 Brush
13" & 17" Hogshair Pads
Wet vac
Poly Protect
Wet floor signs
Proper safety equipment (goggles, gloves and appropriate footwear)

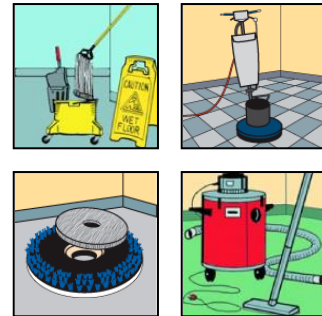

## PRODUCT REQUIRED

Product	Dilution Rate
Pinnacle® Tile Polish #1	RTU
Pinnacle® Tile Polish #2	RTU
StoneMedic CTP-1 Ceramic Tile Polish #1	RTU
StoneMedic CTP-2 Ceramic Tile Polish #2	RTU

## PROCEDURE

### Restorative Polishing

1. Position wet floor signs. Put on proper safety equipment.
2. Apply Poly Protect to surrounding areas and walls.
3. Position CTP-1 brush and 13" pad onto Mighty Max Floor Machine.
4. Apply Tile Polish #1 by scoop to the floor. Add water to make thick slurry.
5. Polish floor until slurry dries.
6. Rewet floor and repeat step 5.
7. Rinse floor with water and remove solution with wet vacuum/autoscrubber or mop and bucket.
8. Remove CTP brush and replace with 17" Hogshair Pad.
9. Apply Tile Polish #2 by scoop to the floor. Add water to make thick slurry.
10. Polish floor until slurry dries.
11. Repeat step 10 if desired shine is not achieved.
12. Rinse floor with water and remove solution with wet vacuum/autoscrubber or mop and bucket.
13. Clean grout lines if necessary (see interim method).
14. Thoroughly clean and store all equipment and pads after use.
15. Remove wet floor signs.

# COMMERCIAL KITCHEN (EPOXY, PVC, MMA) CARE: DAILY MAINTENANCE WITH MOP/BUCKET AND DECK BRUSH

## EQUIPMENT REQUIRED

Damp mop (grease-release)
Mop bucket with wringer
Deck brush and squeegee
Wet floor signs
Proper safety equipment (goggles, gloves and appropriate footwear)

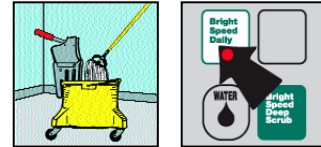

## PRODUCT REQUIRED

Product	Dilution Rate
Oasis 115XP	2-4 oz/gal
Keystone Floor Cleaner	2-4 oz/gal
Oasis 125XP	2-4 oz/gal
Quik Fill 35 MAXX Dual Action Floor Cleaner	½-2 oz/gal
Oasis 560	½-2 oz/gal

## PROCEDURE

### Mop and Bucket

1. Position wet floor signs. Put on proper safety equipment.
2. Use broom or hose to remove debris from the floor and under counters and equipment.
3. Mix cleaning solution with **hot water** in the mop bucket using appropriate dilution rate.
4. Use a grease release mop to apply cleaning solution to floor surface, working in sections.
5. Use deck brush to scrub the floor, including the base coving.
6. Repeat steps 4-5 until the entire floor area has been cleaned.
7. Rinse floor with clean, **hot water**.
8. Squeegee excess solution to drain.
9. Thoroughly clean and store all equipment after use.
10. Remove wet floor signs.

**Special Considerations – For mineral buildup, rotate cleaning with Oasis 125XP. For meat room applications, use Oasis Enforce. For freezer application, use Kool Klene. For petroleum grease marks, use Oasis 560.**

## COMMERCIAL KITCHEN (EPOXY, PVC, MMA) CARE: INTERIM MAINTENANCE WITH LOW SPEED MACHINE OR AUTOSCRUBBER

### EQUIPMENT REQUIRED

Damp mop (grease release)
Mop bucket with wringer
Swing machine
Auto scrubber
Blue or green pads or flagged brush
Wet floor signs
Proper safety equipment (goggles, gloves and appropriate footwear)

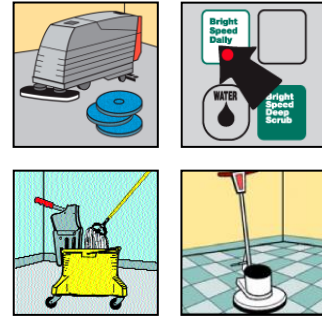

### PRODUCT REQUIRED

Product	Dilution Rate
Oasis 115XP	4 oz/gal
Keystone Floor Cleaner	4 oz/gal
Quik Fill 35 MAXX Dual Action Floor Cleaner	2-4 oz/gal
Oasis 560	2-4 oz/gal

### PROCEDURE

#### Low Speed Machine

1. Position wet floor signs. Put on proper safety equipment.
2. Use broom or hose to remove debris from the floor and under counters and equipment.
3. Mix cleaning solution with **hot water** in the mop bucket using appropriate dilution rate.
4. Position blue or green pad or flagged brush under low speed machine.
5. Use a grease release mop to apply cleaning solution to floor surface, working in sections.
6. Use low speed machine to remove heavy soil or grease buildup from the floor.
7. Repeat steps 4-5 until the entire floor area has been cleaned.
8. Rinse floor with clean, **hot water**.
9. Squeegee excess solution to drain.
10. Thoroughly clean and store all equipment after use.
11. Remove wet floor signs.

#### Autoscrubber

1. Position wet floor signs. Put on proper safety equipment.
2. Use broom or hose to remove debris from the floor and under counters and equipment.
3. Mix cleaning solution in the auto scrubber with **hot water** using appropriate dilution rate.
4. Position the blue or green pad or flagged brush onto the auto scrubber.
5. With the auto scrubber, use the "double scrub" method:
  - a. Apply the solution with the pads down, squeegee up and the vacuum off.
  - b. Make a second pass with the pads down, squeegee down and the vacuum on.
6. Mop the corners and edges manually and remove any excess solution.
7. Rinse the floor with clean water using single pass with the autoscrubber.
8. Thoroughly clean and store all equipment and pads after use.
9. Remove wet floor signs.

## COMMERCIAL KITCHEN (EPOXY, PVC, MMA) CARE: RESTORATIVE MAINTENANCE

*For refinishing epoxy, PVC, MMA, vinyl or urethane, refer to manufacturer's specifications.*

# CONCRETE CARE: DAILY MAINTENANCE WITH AUTOMATIC SCRUBBER AND MOP/BUCKET

## EQUIPMENT REQUIRED

Damp mop (cotton or synthetic)
Mop bucket with wringer
Auto scrubber
Red pads
Wet floor signs
Proper safety equipment (goggles, gloves and appropriate footwear)

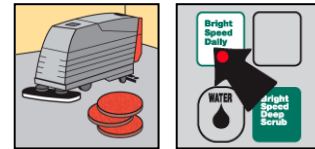

## PRODUCT REQUIRED

Product	Dilution Rate
Quik Fill 35 MAXX Dual Action Floor Cleaner	1/8-1/4 oz/gal
QC 35 MAXX Dual Action Floor Cleaner	1/4-1/2 oz/gal
Quik Fill 34 Neutral Floor Cleaner	1/2-2 oz/gal
QC 34 High Performance UC Neutral Floor Cleaner	1/4-1 oz/gal
FACILIPRO™ Alkaline Floor Cleaner	1/8-1/4 oz/gal
FACILIPRO™ Neutral Floor Cleaner	1/2-2 oz/gal
FACILIPRO™ Concentrated Neutral Floor Cleaner	1/4-1 oz/gal

## PROCEDURE

### Automatic Scrubber

1. Position wet floor signs. Put on proper safety equipment.
2. Use broom to sweep accumulated soil from the floor surface into dust pan for disposal.
3. Mix cleaning solution in the auto scrubber and mop bucket using appropriate dilution rate.
4. Position the red pad onto the auto scrubber.
5. Using the auto scrubber, apply the cleaning solution, scrub and pick up residue.
6. Mop the corners and edges manually and remove any excess solution.
7. Thoroughly clean and store all equipment and pads after use.
8. Remove wet floor signs.

### Mop and Bucket

1. Position wet floor signs. Put on proper safety equipment.
2. Use broom to sweep accumulated soil from the floor surface into dust pan for disposal.
3. Mix cleaning solution in the mop bucket using appropriate dilution rate per gallon of water.
4. Use a cotton or synthetic mop with cleaning solution.
5. Partially wring out mop and apply cleaning solution to approximately 10' by 10' area of floor surface. Thoroughly wring out mop in bucket and pick up excess solution.
6. Repeat step 4 until the entire floor area has been cleaned.
7. Thoroughly clean and store all equipment after use.
8. Remove wet floor signs.

# CONCRETE CARE: INTERIM MAINTENANCE WITH IMPREGNATION

## EQUIPMENT REQUIRED

Damp mop (cotton or synthetic)
Mop bucket or autoscrubber with red pad
Deck brush
Low speed machine with brush
Wet floor signs
Proper safety equipment (goggles, gloves and appropriate footwear)

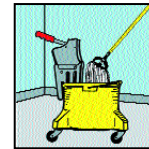
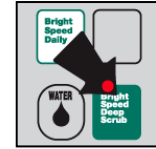
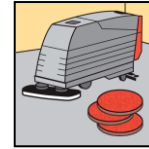

## PRODUCT REQUIRED

Product	Dilution Rate
Quik Fill 35 MAXX Dual Action Floor Cleaner	1 oz/gal
QC 35 MAXX Dual Action Floor Cleaner	2 oz/gal
Pinnacle® Grout Line Impregnator	RTU
FACILIPRO Alkaline Floor Cleaner	1 oz/gal
StoneMedic® CGI Ceramic Grout Impregnator	RTU

## PROCEDURE

### Interim Cleaning

1. Position wet floor signs. Put on proper safety equipment.
2. Mix cleaning solution in the auto scrubber and mop bucket using appropriate dilution rate.
3. Position the red pad onto the auto scrubber.
4. Using the auto scrubber, apply the cleaning solution, scrub and pick up residue.
5. Mop the corners and edges manually and remove any excess solution.
6. Thoroughly clean and store all equipment and pads after use.
7. Remove wet floor signs.

### Concrete Impregnation

1. Position wet floor signs. Put on proper safety equipment.
2. Apply Impregnator to concrete with roller or sprayer.
3. Work product into concrete with deck brush or low speed machine and a white pad if surface is polished.
4. Let sit 10 minutes to absorb into concrete.
5. Squeegee excess product and tack up excess with a cotton towel.
6. A second coat can be applied 2 -6 hours after initial application for absorbent surfaces.
7. Allow 6 – 8 hours to dry thoroughly before allowing foot traffic.
8. Thoroughly clean and store all equipment after use.
9. Remove wet floor signs.

**For Interim Maintenance of Finished Concrete, See Resilient Floor Finishing Maintenance Guide – Page 83**



# CONCRETE CARE: RESTORATIVE MAINTENANCE WITH POLISHING

## EQUIPMENT REQUIRED

Damp mop (cotton or synthetic)
Mighty Max + extra weights (40 – 60 lbs) or ProGrind
Metal grade diamonds
Galaxy or Turbo diamonds
Wet vac
Wet floor signs
Proper safety equipment (goggles, gloves and appropriate footwear)

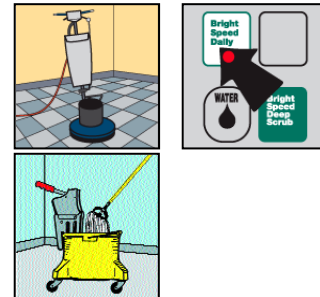

## PRODUCT REQUIRED

Product	Dilution Rate
Pinnacle® Grout Line Impregnator	RTU
StoneMedic® CGI Ceramic Grout Impregnator	RTU

## PROCEDURE

### Wet Restorative Polishing

1. Position wet floor signs. Put on proper safety equipment.
2. Place lowest grit metal bond diamonds onto machine.
3. Grind floor making six passes over the designated area or until desired outcome is achieved.
4. Rinse with water and vacuum with wet vac.
5. Place next grit metal bond diamonds on machine and repeat steps 3-4.
6. After 400 grit metal, switch to Galaxy diamonds if a high shine is desired.
7. Increase grit until desired shine is achieved.
8. After 24 hours drying time, apply Impregnator.
9. Thoroughly clean and store all equipment after use.
10. Remove wet floor signs.

### Dry Restorative Polishing

1. Position wet floor signs. Put on proper safety equipment.
2. Place lowest grit metal bond diamonds onto machine.
3. Grind floor making six passes over the designated area or until desired outcome is achieved.
4. Rinse with water and vacuum with wet vac.
5. Place next grit metal bond diamonds on machine and repeat steps 3-4.
6. After 400 grit metal, switch to Turbo diamonds if a high shine is desired. **Do not add water when polishing with Turbo diamonds for this process.**
7. Increase grit until desired shine is achieved.
8. After 24 hours drying time, apply Impregnator.
9. Thoroughly clean and store all equipment after use.
10. Remove wet floor signs.

**For Restorative Maintenance of Finished Concrete, See Resilient Floor Finishing Maintenance Guide – Pages 84-91**

# CONCRETE (STAINED) CARE: DAILY MAINTENANCE WITH AUTOMATIC SCRUBBER AND MOP/BUCKET

## EQUIPMENT REQUIRED

Damp mop (cotton or synthetic)
Mop bucket with wringer
Auto scrubber
Red pads
Wet floor signs
Proper safety equipment (goggles, gloves and appropriate footwear)

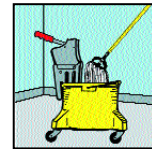
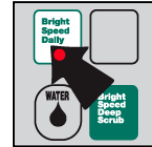
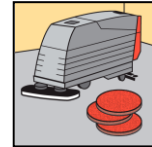

## PRODUCT REQUIRED

Product	Dilution Rate
Quik Fill 35 MAXX Dual Action Floor Cleaner	$\frac{1}{8}$ - $\frac{1}{4}$ oz/gal
QC 35 MAXX Dual Action Floor Cleaner	$\frac{1}{4}$ - $\frac{1}{2}$ oz/gal
Quik Fill 34 Neutral Floor Cleaner	$\frac{1}{2}$ -2 oz/gal
QC 34 High Performance UC Neutral Floor Cleaner	$\frac{1}{4}$ -1 oz/gal
FACILIPRO™ Alkaline Floor Cleaner	$\frac{1}{8}$ - $\frac{1}{4}$ oz/gal
FACILIPRO™ Neutral Floor Cleaner	$\frac{1}{2}$ -2 oz/gal
FACILIPRO™ Concentrated Neutral Floor Cleaner	$\frac{1}{4}$ -1 oz/gal

## PROCEDURE

### Automatic Scrubber

1. Position wet floor signs. Put on proper safety equipment.
2. Use broom to sweep accumulated soil from the floor surface into dust pan for disposal.
3. Mix cleaning solution in the auto scrubber and mop bucket using appropriate dilution rate.
4. Position the red pad onto the auto scrubber.
5. Using the auto scrubber, apply the cleaning solution, scrub and pick up residue.
6. Mop the corners and edges manually and remove any excess solution.
7. Thoroughly clean and store all equipment and pads after use.
8. Remove wet floor signs.

### Mop and Bucket

1. Position wet floor signs. Put on proper safety equipment.
2. Use broom to sweep accumulated soil from the floor surface into dust pan for disposal.
3. Mix cleaning solution in the mop bucket using appropriate dilution rate per gallon of water.
4. Use a cotton or synthetic mop with cleaning solution.
5. Partially wring out mop and apply cleaning solution to approximately 10' by 10' area of floor surface. Thoroughly wring out mop in bucket and pick up excess solution.
6. Repeat step 4 until the entire floor area has been cleaned.
7. Thoroughly clean and store all equipment after use.
8. Remove wet floor signs.

## **CONCRETE (STAINED) CARE: INTERIM MAINTENANCE**

*See Resilient Floor Finishing- Maintenance Guide Page 83*

*Special Considerations – To maintain alcohol sanitizer resistance, spray buff or maintainer products should not be used on Hybrid finishes.*

## **CONCRETE (STAINED) CARE: RESTORATIVE MAINTENANCE**

*See Resilient Floor Finishing Maintenance Guide – Pages 84-91*

*Special Considerations – Apply 2 coats of Rivet Concrete Sealer prior to finish application.*

## CORK CARE: DAILY MAINTENANCE WITH DUST MOPPING

### EQUIPMENT REQUIRED

Walk off mats
Treated dust mop
Cotton Towels
Proper safety equipment (goggles, gloves and appropriate footwear)

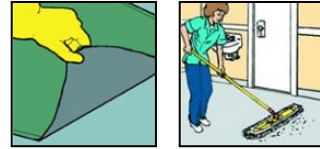

### PRODUCT REQUIRED

Product	Dilution Rate
Huntolene® Dust Mop Treatment	RTU
Full Court™ Wood Floor Cleaner	2-4 oz/gal

### PROCEDURE

1. Pick up and dispose of debris. Remove gum from floor.
2. Use Huntolene® treated broom to sweep accumulated soil from the floor surface into dust pan for disposal.
3. Clean up spills with Full Court™ wood floor cleaner and remove any moisture on the floor. Place "Wet Floor" signs until floor dries.
4. Vacuum floor mats.

# CORK CARE: INTERIM MAINTENANCE WITH DAMP MOPPING

## EQUIPMENT REQUIRED

Walk off mats
Dust mop
Mop and bucket with wringer
Proper safety equipment (goggles, gloves and appropriate footwear)

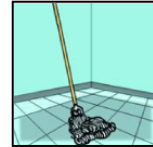

## PRODUCT REQUIRED

Product	Dilution Rate
Huntolene® Dust Mop Treatment	RTU
Full Court™ Wood Floor Cleaner	2-4 oz/gal

## PROCEDURE

1. Repeat daily maintenance.
2. Place "Wet Floor" signs until floor dries.
3. Damp mop the floor with Full Court™ wood floor cleaner.

# CORK CARE: RESTORATIVE MAINTENANCE WITH SCREENING AND REFINISHING

## EQUIPMENT REQUIRED

Low speed swing machine
120 mesh screen or maroon pad
Wet vac or floor vac with wand
Push broom and mop bucket with wringer
White towels
T-bar (weighted for oil based finishes)
Proper safety equipment (goggles, gloves and appropriate footwear)

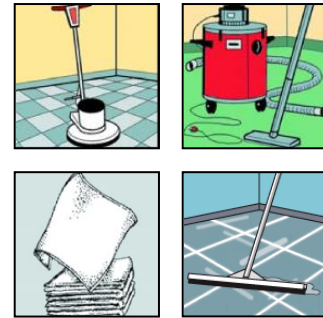

## PRODUCT REQUIRED

Product	Dilution Rate
Front Court™ (water based finish)	RTU
Classic 50 Ultra™ (oil based finish)	RTU

## PROCEDURE

1. Position wet floor signs. Put on proper safety equipment.
2. Place 120 mesh screen or maroon pad onto swing machine.
3. Lightly screen the floor in the direction of the boards. This should be a quick screening to rough up the surface so the next coat of finish can adhere.
4. Dry vacuum the entire floor in the direction of the boards.
5. Tack the floor - soak white towels in a mop bucket, wring them out as much as possible. Drape the damp towel over the head of a push broom and push the broom across the floor in the direction of the boards with either water or a solvent to remove fine dust. If you are going to apply a water based finish, tack with water. If you are going to use an oil based finish, tack with a solvent.
6. Repeat step 5 until all dust is removed from the floor. If any dust is removed after running your hand over the floor repeat step 5.
7. Allow floor to dry before applying finish.
8. Finish application - place synthetic head onto T-bar applicator. If applying a water based finish, use a non-weighted T-bar. If applying an oil based finish, use a weighted T-bar.
9. Pour finish onto floor in a line running with the boards down one side of the room. Using the T-bar applicator spread the initial line of product up to the wall.
10. Starting at one end of the room, spread the product in the direction of the boards, making sure to angle the head of the applicator towards yourself so that any excess finish is pushed onto the next area to be coated. When you get to the end of the room turn the applicator towards yourself and pull excess finish onto the next area to be coated.
11. Place the applicator head on the floor and push down to remove any excess finish.
12. Repeat steps 9 – 11 until the room is coated. On the last section of floor, spread product side to side with applicator to smooth it out, and exit the room.
13. Thoroughly clean and store all equipment after use.

**Special Considerations: Aluminum oxide coatings can have adhesions issues. Ecolab product recommendation for urethane finish – Front Court™**

# ENGINEERED STONE (AGGLOMERATE) CARE: DAILY MAINTENANCE WITH AUTOMATIC SCRUBBER AND MOP/BUCKET

## EQUIPMENT REQUIRED

Treated dust mop
Damp mop (cotton or synthetic)
Mop bucket with wringer
Auto scrubber
Red pads
Wet floor signs
Proper safety equipment (goggles, gloves and appropriate footwear)

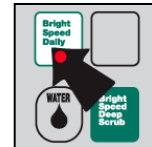
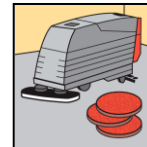

## PRODUCT REQUIRED

Product	Dilution Rate
Quik Fill 35 MAXX Dual Action Floor Cleaner	$\frac{1}{8}$ - $\frac{1}{4}$ oz/gal
QC 35 MAXX Dual Action Floor Cleaner	$\frac{1}{4}$ - $\frac{1}{2}$ oz/gal
Quik Fill 34 Neutral Floor Cleaner	$\frac{1}{2}$ -2 oz/gal
QC 34 High Performance UC Neutral Floor Cleaner	$\frac{1}{4}$ -1 oz/gal
FACILIPRO™ Alkaline Floor Cleaner	$\frac{1}{8}$ - $\frac{1}{4}$ oz/gal
FACILIPRO™ Neutral Floor Cleaner	$\frac{1}{2}$ -2 oz/gal
FACILIPRO™ Concentrated Neutral Floor Cleaner	$\frac{1}{4}$ -1 oz/gal

## PROCEDURE

### Automatic Scrubber

1. Position wet floor signs. Put on proper safety equipment.
2. Use treated broom to sweep accumulated soil from the floor surface into dust pan for disposal.
3. Mix cleaning solution in the auto scrubber and mop bucket using appropriate dilution rate.
4. Position the red pad onto the auto scrubber.
5. Using the auto scrubber, apply the cleaning solution, scrub and pick up residue in one operation.
6. Mop the corners and edges manually and remove any excess solution.
7. Thoroughly clean and store all equipment and pads after use.
8. Remove wet floor signs.

### Mop and Bucket

1. Position wet floor signs. Put on proper safety equipment.
2. Use treated broom to sweep accumulated soil from the floor surface into dust pan for disposal.
3. Mix cleaning solution in the mop bucket using appropriate dilution rate per gallon of water.
4. Use a cotton or synthetic mop with cleaning solution.
5. Partially wring out mop and apply cleaning solution to approximately 10' by 10' area of floor. Thoroughly wring out mop in bucket and pick up excess solution from the 10' by 10' area.
6. Repeat step 4 until the entire floor area has been cleaned.
7. Thoroughly clean and store all equipment after use.
8. Remove wet floor signs.



## ENGINEERED STONE (AGGLOMERATE) CARE: INTERIM MAINTENANCE WITH GROUT IMPREGNATION

### EQUIPMENT REQUIRED

Damp mop (cotton or synthetic)
Mop bucket or autoscrubber with red pad
Deck brush
Low speed machine with brush
Wet floor signs
Proper safety equipment (goggles, gloves and appropriate footwear)

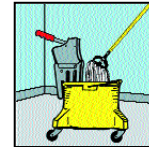
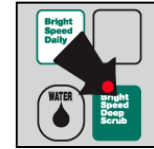
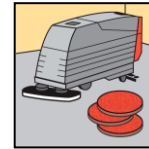

### PRODUCT REQUIRED

Product	Dilution Rate
Pinnacle® Intensive Tile Cleaner	12-64 oz/gal
Pinnacle® Grout Line Impregnator	RTU
StoneMedic® CIC Ceramic Intensive Cleaner	12-64 oz/gal
StoneMedic® CGI Ceramic Grout Impregnator	RTU

### PROCEDURE

#### Interim Cleaning

1. Position wet floor signs. Put on proper safety equipment.
2. Apply Intensive Tile Cleaner to the floor at the proper dilution with lukewarm water using a mop and bucket or autoscrubber.
3. Initial quick agitation (low speed machine/autoscrubber with brush or deck brush).
4. Allow to dwell for 6 to 10 minutes.
5. Scrub well into grout lines (low speed machine/autoscrubber with brush or deck brush).
6. Remove solution with wet vacuum/autoscrubber or mop and bucket.
7. Rinse with a fresh water solution.
8. Thoroughly clean and store all equipment and pads after use.
9. Remove wet floor signs.

#### Grout Line Impregnation

1. Position wet floor signs. Put on proper safety equipment.
2. Apply Grout Line Impregnator to grout lines with roller, pump up or electric sprayer.
3. Work product into grout lines with deck brush or low speed machine and a white pad.
4. Let sit 10 minutes to absorb into grout.
5. Squeegee excess product from tiles and grout lines, crossing the tiles on a diagonal.
6. Tack up excess with a cotton towel.
7. Allow 6 – 8 hours to dry thoroughly before allowing foot traffic.
8. Thoroughly clean and store all equipment after use.
9. Remove wet floor signs.

## ENGINEERED STONE (AGGLOMERATE) CARE: RESTORATIVE MAINTENANCE

*For stone polishing or honing, refer to manufacturer's specifications.*

# EPOXY (PAINTED) CARE: DAILY MAINTENANCE WITH AUTOMATIC SCRUBBER AND MOP/BUCKET

## EQUIPMENT REQUIRED

Dust mop
Damp mop (cotton or synthetic)
Mop bucket with wringer
Auto scrubber
Red pads
Wet floor signs
Proper safety equipment (goggles, gloves and appropriate footwear)

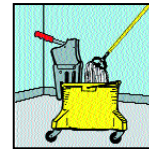
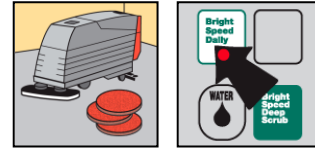

## PRODUCT REQUIRED

Product	Dilution Rate
Quik Fill 35 MAXX Dual Action Floor Cleaner	1/8-1/4 oz/gal
QC 35 MAXX Dual Action Floor Cleaner	1/4-1/2 oz/gal
Quik Fill 34 Neutral Floor Cleaner	1/2-2 oz/gal
QC 34 High Performance UC Neutral Floor Cleaner	1/4-1 oz/gal
Oasis 560	1/2-2 oz/gal
FACILIPRO™ Alkaline Floor Cleaner	1/8-1/4 oz/gal
FACILIPRO™ Concentrated Alkaline Floor Cleaner	1/4-1/2 oz/gal
FACILIPRO™ Neutral Floor Cleaner	1/2-2 oz/gal
FACILIPRO™ Concentrated Neutral Floor Cleaner	1/4-1 oz/gal

## PROCEDURE

### Automatic Scrubber

1. Position wet floor signs. Put on proper safety equipment.
2. Use broom to sweep accumulated soil from the floor surface into dust pan for disposal.
3. Mix cleaning solution in the auto scrubber and mop bucket using appropriate dilution rate.
4. Position the red pad onto the auto scrubber.
5. Using the auto scrubber, apply the cleaning solution, scrub and pick up residue in one operation.
6. Mop the corners and edges manually and remove any excess solution.
7. Thoroughly clean and store all equipment and pads after use.
8. Remove wet floor signs.

### Mop and Bucket

1. Position wet floor signs. Put on proper safety equipment.
2. Use broom to sweep accumulated soil from the floor surface into dust pan for disposal.
3. Mix cleaning solution in the mop bucket using appropriate dilution rate per gallon of water.
4. Use a cotton or synthetic mop with cleaning solution.
5. Partially wring out mop and apply cleaning solution to approximately 10' by 10' area of floor surface. Thoroughly wring out mop in bucket and pick up excess solution from the area.
6. Repeat step 4 until the entire floor area has been cleaned.
7. Thoroughly clean and store all equipment after use.
8. Remove wet floor signs.

**Special Considerations – For petroleum grease marks, use Oasis 560.**

## EPOXY (PAINTED) CARE: INTERIM MAINTENANCE WITH AUTOMATIC SCRUBBER

### EQUIPMENT REQUIRED

Auto scrubber
Red pads
Wet floor signs
Proper safety equipment (goggles, gloves and appropriate footwear)

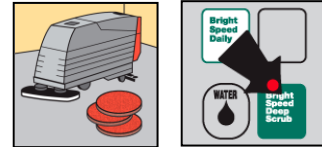

### PRODUCT REQUIRED

Product	Dilution Rate
Quik Fill 35 MAXX Dual Action Floor Cleaner	1 oz/gal
QC 35 MAXX Dual Action Floor Cleaner	2 oz/gal
Oasis 560	2-4 oz/gal
FACILIPRO™ Alkaline Floor Cleaner	1 oz/gal
FACILIPRO™ Concentrated Alkaline Floor Cleaner	2 oz/gal

### PROCEDURE

#### Automatic Scrubber

1. Dust mop floor.
2. Position wet floor signs. Put on proper safety equipment.
3. Mix cleaning solution in the auto scrubber and mop bucket using appropriate dilution rate per gallon of water.
4. Position the red pad onto the auto scrubber.
5. Using the auto scrubber, apply the cleaning solution, scrub and pick up residue in one operation.
6. Mop the corners and edges manually and remove any excess solution not recovered by the auto scrubber.
7. Thoroughly clean and store all equipment and pads after use.
8. Remove wet floor signs.

## EPOXY (PAINTED) CARE: RESTORATIVE MAINTENANCE

*For refinishing epoxy, refer to manufacturer's specifications.*

# GRANITE CARE: DAILY MAINTENANCE WITH AUTOMATIC SCRUBBER AND MOP/BUCKET

## EQUIPMENT REQUIRED

Treated dust mop
Damp mop (cotton or synthetic)
Mop bucket with wringer
Auto scrubber
Red pads
Wet floor signs
Proper safety equipment (goggles, gloves and appropriate footwear)

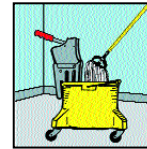
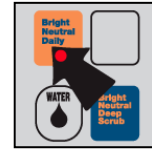
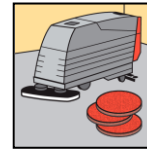

## PRODUCT REQUIRED

Product	Dilution Rate
Pinnacle® Floor Cleaner/Conditioner	1-1 ½ oz/gal
StoneMedic® DCC Daily Cleaner/Conditioner	1-1 ½ oz/gal
Quik Fill 34 Neutral Floor Cleaner	½-2 oz/gal
QC 34 High Performance UC Neutral Floor Cleaner	¼-1 oz/gal
FACILIPRO™ Neutral Floor Cleaner	½-2 oz/gal
FACILIPRO™ Concentrated Neutral Floor Cleaner	¼-1 oz/gal

## PROCEDURE

### Automatic Scrubber

1. Position wet floor signs. Put on proper safety equipment.
2. Use treated broom to sweep accumulated soil from the floor surface into dust pan for disposal.
3. Mix cleaning solution in the auto scrubber and mop bucket using appropriate dilution rate.
4. Position the red pad onto the auto scrubber.
5. Using the auto scrubber, apply the cleaning solution, scrub and pick up residue in one operation.
6. Mop the corners and edges manually and remove any excess solution not recovered by the auto scrubber.
7. Thoroughly clean and store all equipment and pads after use.
8. Remove wet floor signs.

### Mop and Bucket

1. Position wet floor signs. Put on proper safety equipment.
2. Use treated broom to sweep accumulated soil from the floor surface into dust pan for disposal.
3. Mix cleaning solution in the mop bucket using appropriate dilution rate per gallon of water.
4. Use a cotton or synthetic mop with cleaning solution.
5. Partially wring out mop and apply cleaning solution to approximately 10' by 10' area of floor surface. Thoroughly wring out mop in bucket and pick up excess solution from the 10' by 10' area.
6. Repeat step 4 until the entire floor area has been cleaned.
7. Thoroughly clean and store all equipment after use.
8. Remove wet floor signs.

# GRANITE CARE: INTERIM MAINTENANCE WITH POLISHING AND IMPREGNATION

## EQUIPMENT REQUIRED

Damp mop (cotton or synthetic)
Mop bucket or autoscrubber with red pad
#0 Steel Wool
Mighty Max plus extra weights (40-60 lbs)
Pump up sprayer
Wet vac
Wet floor signs
Proper safety equipment (goggles, gloves and appropriate footwear)

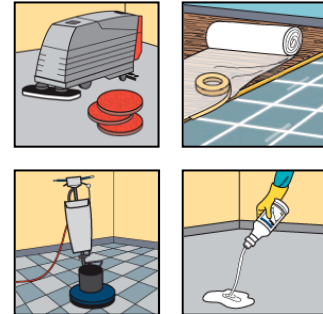

## PRODUCT REQUIRED

Product	Dilution Rate
Linoleum Floor Stripper	12 oz/gal
Pinnacle® Granite Polish Cream	RTU
Pinnacle® Marble & Terrazzo Crystallizer	RTU
Pinnacle® Grout Line Impregnator	RTU
StoneMedic® GPC Granite Polishing Compound	RTU
StoneMedic® TMC Terrazzo & Marble Crystallizer	RTU
StoneMedic® CGI Ceramic Grout Impregnator	RTU

## PROCEDURE

### Interim Cleaning

1. Dust mop floor.
2. Position wet floor signs. Put on proper safety equipment.
3. Apply Linoleum Stripper to the floor at the proper dilution with lukewarm water using a mop and bucket or autoscrubber.
4. Remove solution with wet vacuum/autoscrubber or mop and bucket.
5. Rinse with a fresh water solution.
6. Thoroughly clean and store all equipment and pads after use.
7. Remove wet floor signs.

### Traffic Lane Polishing

1. Position wet floor signs. Put on proper safety equipment.
2. Section off and cover areas that do not need polish.
3. Apply Granite Polish Cream to the floor and add a small amount of Marble & Terrazzo Crystallizer for lubrication.
4. Polish floor using the Mighty Max and #0 steel wool pad until the polish disappears and desired shine is achieved. Apply more crystallizer if needed.
5. Repeat steps 3-4 until desired shine is achieved.
6. Rinse with a fresh water solution if needed.
7. Thoroughly clean and store all equipment and pads after use.
8. Remove wet floor signs.

## **GRANITE CARE: INTERIM MAINTENANCE WITH POLISHING AND IMPREGNATION (CON'T)**

### **Granite Impregnation**

1. Position wet floor signs. Put on proper safety equipment.
2. Apply Impregnator to tiles with roller, pump up or electric sprayer.
3. Let sit 10 minutes to absorb into grout.
4. Squeegee excess product from tiles and grout lines, crossing the tiles on a diagonal.
5. Tack up excess with a cotton towel.
6. Allow 6 – 8 hours to dry thoroughly before allowing foot traffic.
7. Thoroughly clean and store all equipment after use.
8. Remove wet floor signs.

***Special Considerations: When using Crystallizer on white or light granite the steel wool pad can cause a black haze. To remove, apply a small amount of Crystallizer and buff with a white pad.***

# GRANITE CARE: RESTORATIVE MAINTENANCE WITH DIAMOND GRINDING

## EQUIPMENT REQUIRED

Mighty Max and extra weights (40-60 lbs)
Turbo diamonds
White pad
#0 Jumbo Steel Wool pad
Wet vac
Poly protect
Wet floor signs
Proper safety equipment (goggles, gloves and appropriate footwear)

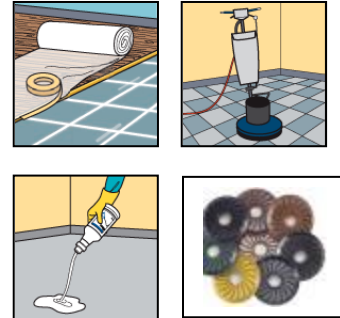

## PRODUCT REQUIRED

Product	Dilution Rate
Pinnacle® Granite Polish Cream	RTU
Pinnacle® Marble & Terrazzo Crystallizer	RTU
StoneMedic® GPC Granite Polishing Compound	RTU
StoneMedic® TMC Terrazzo & Marble Crystallizer	RTU

## PROCEDURE

### Diamond Grinding

1. Position wet floor signs. Put on proper safety equipment. Place poly protect on surrounding area, including walls and adjacent floors.
2. Place 100 grit Turbo diamonds onto machine.
3. Add small amount of water to floor. Grind floor making twelve passes over the designated area or until scratches are removed and the floor is uniform (dull) in appearance.
4. Rinse with water and vacuum with wet vac.
5. Place next grit Turbo diamonds on machine and repeat steps 3-4.
6. Increase grit until 3500 grit and desired shine is achieved.
7. Rinse with water and vacuum with wet vac.
8. Sandwich white pad on driver and place steel wool pad onto floor.
9. Apply Granite Polish Cream to floor and add Marble & Terrazzo Crystallizer to increase lubricity.
10. Polish until Granite Polish Cream is gone – reapply Marble & Terrazzo Crystallizer if needed.
11. Rinse if needed.
12. Thoroughly clean and store all equipment after use.
13. Remove wet floor signs

**Special Considerations:** When using Crystallizer on white or light granite the steel wool pad can cause a black haze. To remove, apply a small amount of Crystallizer and buff with a white pad.

# LIMESTONE/TRAVERTINE CARE: DAILY MAINTENANCE WITH AUTOMATIC SCRUBBER OR MOP/BUCKET

## EQUIPMENT REQUIRED

Treated dust mop
Damp mop (cotton or synthetic)
Mop bucket with wringer
Auto scrubber
Red pads (or brush if not filled and honed)
Wet floor signs
Proper safety equipment (goggles, gloves and appropriate footwear)

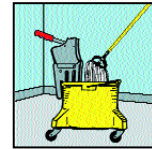
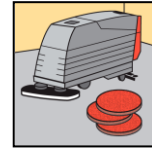

## PRODUCT REQUIRED

Product	Dilution Rate
Pinnacle® Floor Cleaner/Conditioner	1-1 ½ oz/gal
StoneMedic® DCC Daily Cleaner/Conditioner	1-1 ½ oz/gal
Quik Fill 34 Neutral Floor Cleaner	½-2 oz/gal
QC 34 High Performance UC Neutral Floor Cleaner	¼-1 oz/gal
FACILIPRO™ Neutral Floor Cleaner	½-2 oz/gal
FACILIPRO™ Concentrated Neutral Floor Cleaner	¼-1 oz/gal

## PROCEDURE

### Automatic Scrubber

1. Position wet floor signs. Put on proper safety equipment.
2. Use broom to sweep accumulated soil from the floor surface into dust pan for disposal.
3. Mix cleaning solution in the auto scrubber and mop bucket using appropriate dilution rate.
4. Position the red pad or brush onto the auto scrubber.
5. Using the auto scrubber, apply the cleaning solution, scrub and pick up residue in one operation.
6. Mop the corners and edges manually and remove any excess solution not recovered by the auto scrubber.
7. Thoroughly clean and store all equipment and pads after use.
8. Remove wet floor signs.

### Mop and Bucket

1. Position wet floor signs. Put on proper safety equipment.
2. Use broom to sweep accumulated soil from the floor surface into dust pan for disposal.
3. Mix cleaning solution in the mop bucket using appropriate dilution rate per gallon of water.
4. Use a cotton or synthetic mop with cleaning solution.
5. Partially wring out mop and apply cleaning solution to approximately 10' by 10' area of floor surface. Thoroughly wring out mop in bucket and pick up excess solution from the area.
6. Repeat step 4 until the entire floor area has been cleaned.
7. Thoroughly clean and store all equipment after use.
8. Remove wet floor signs.



# LIMESTONE/TRAVETINE CARE: INTERIM MAINTENANCE WITH IMPREGNATION

## EQUIPMENT REQUIRED

Damp mop (cotton or synthetic)
Mop bucket
Autoscrubber with red pad or brush (if not honed and filled)
Deck brush
Low speed machine with brush
Wet vac
Wet floor signs
Proper safety equipment (goggles, gloves and appropriate footwear)

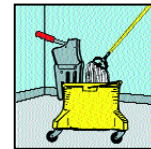
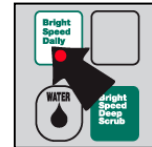
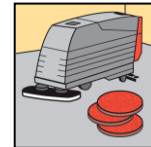

## PRODUCT REQUIRED

Product	Dilution Rate
Linoleum Floor Stripper	12 oz/gal
Pinnacle® Grout Line Impregnator	RTU
StoneMedic® CGI Ceramic Grout Impregnator	RTU

## PROCEDURE

### Interim Cleaning

1. Dust mop floor.
2. Position wet floor signs. Put on proper safety equipment.
3. Mix Linoleum Floor Stripper in the auto scrubber and mop bucket using appropriate dilution rate.
4. Position the red pad or brush onto the auto scrubber.
5. Using the auto scrubber, apply the cleaning solution, scrub and pick up residue in one operation.
6. Mop the corners and edges manually and remove any excess solution not recovered by the auto scrubber.
7. Thoroughly clean and store all equipment and pads after use.
8. Remove wet floor signs.

### Limestone/Travertine Impregnation

1. Position wet floor signs. Put on proper safety equipment.
2. Apply Impregnator to limestone with roller or sprayer.
3. Work product into limestone with deck brush or low speed machine and a white pad.
4. Let sit 10 minutes to absorb into floor.
5. Squeegee excess product and tack up excess with a cotton towel.
6. Allow 6 – 8 hours to dry thoroughly before allowing foot traffic.
7. Thoroughly clean and store all equipment after use.
8. Remove wet floor signs.

# LIMESTONE/TRAVERTINE CARE: RESTORATIVE MAINTENANCE WITH DIAMOND GRINDING

## EQUIPMENT REQUIRED

Mighty Max
Galaxy diamonds
White pad
Hogshair pad or Tampico brush
Wet vac
Poly protect
Wet floor signs
Proper safety equipment (goggles, gloves and appropriate footwear)

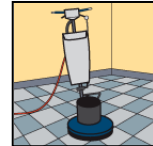
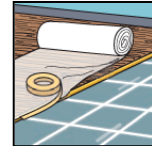

## PRODUCT REQUIRED

Product	Dilution Rate
Pinnacle® Marble Polish Paste	RTU
StoneMedic MPC Marble Polishing Compound	RTU

## PROCEDURE

1. Position wet floor signs. Put on proper safety equipment. Place poly protect on surrounding
2. Place lowest grit Galaxy diamonds needed (for removing scratches) onto machine.
3. Add small amount of water to floor. Grind floor, making six passes over the designated area or until scratches are removed and the floor is uniform (dull) in appearance.
4. Rinse with water and vacuum with wet vac.
5. Place next grit Galaxy diamonds on machine and repeat steps 3-4.
6. Increase grit until desired shine is achieved.
7. Rinse with water and vacuum with wet vac.
8. Place hogshair pad or Tampico brush onto machine.
9. Apply Marble Polish Paste to floor and add small amount of water to create a thick slurry.
10. Polish with six passes or until desired shine is achieved.
11. Rinse with fresh water and wet vac.
12. When floor is dry, place white pad onto machine and buff floor to remove residue.
13. Thoroughly clean and store all equipment and pads after use.
14. Remove wet floor signs.

**Special Considerations:** For restoring lighter limestone go to a minimum of 400 grit and darker limestone to 800-1500 grit.

# LINOLEUM CARE: DAILY MAINTENANCE WITH AUTOMATIC SCRUBBER OR MOP/BUCKET

## EQUIPMENT REQUIRED

Dust mop
Damp mop (cotton or synthetic)
Mop bucket with wringer
Auto scrubber
Red pads
Wet floor signs
Proper safety equipment (goggles, gloves and appropriate footwear)

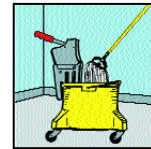
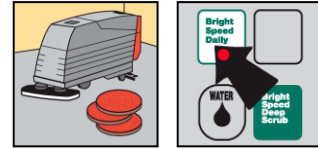

## PRODUCT REQUIRED

Product	Dilution Rate
Quik Fill 35 MAXX Dual Action Floor Cleaner	1/8-1/4 oz/gal
QC 35 MAXX Dual Action Floor Cleaner	1/4-1/2 oz/gal
Quik Fill 34 Neutral Floor Cleaner	1/2-2 oz/gal
QC 34 High Performance UC Neutral Floor Cleaner	1/4-1 oz/gal
FACILIPRO™ Alkaline Floor Cleaner	1/8-1/4 oz/gal
FACILIPRO™ Concentrated Alkaline Floor Cleaner	1/4-1/2 oz/gal
FACILIPRO™ Neutral Floor Cleaner	1/2-2 oz/gal
FACILIPRO™ Concentrated Neutral Floor Cleaner	1/4-1 oz/gal

## PROCEDURE

### Automatic Scrubber

1. Position wet floor signs. Put on proper safety equipment.
2. Use broom to sweep accumulated soil from the floor surface into dust pan for disposal. **Do not use oil based dust mop sweeping solutions as they will soften the tiles.**
3. Mix cleaning solution in the auto scrubber using appropriate dilution rate per gallon of water.
4. Position the red pad onto the auto scrubber.
5. Using the auto scrubber, apply the cleaning solution, scrub and pick up residue in one operation.
6. Mop corners and edges manually. Remove excess solution not recovered by the auto scrubber.
7. Thoroughly clean and store all equipment and pads after use. Remove wet floor signs.
8. Burnish as needed (see Resilient Floor Finishing Maintenance Guide – Page 82). **Do not use ultra high speed burnishers (>2500 rpm). Propane burnishers should not be used.**

### Mop and Bucket

1. Position wet floor signs. Put on proper safety equipment.
2. Use broom to sweep accumulated soil from the floor surface into dust pan for disposal. **Do not use oil based dust mop sweeping solutions as they will soften the tiles.**
3. Mix cleaning solution in the mop bucket using appropriate dilution rate per gallon of water.
4. Use a cotton or synthetic mop with cleaning solution.
5. Partially wring out mop and apply cleaning solution to approximately 10' by 10' area of floor surface. Thoroughly wring out mop in bucket and pick up excess solution from the area.
6. Repeat step 4 until the entire floor area has been cleaned.
7. Thoroughly clean and store all equipment after use. Remove wet floor signs.
8. Burnish as needed (see Resilient Floor Finishing Maintenance Guide – Page 82). **Do not use ultra high speed burnishers (>2500 rpm). Propane burnishers should not be used.**

**Special Considerations – If disinfection of finished floors is required, use Hybrid finishes to prevent stickiness from quats.**

## LINOLEUM CARE: INTERIM MAINTENANCE

See Resilient Floor Finishing Maintenance Guide – Page 83

*Special Considerations – Do not use ultra high speed burnishers (>2500 rpm). Propane burnishers should not be used. To maintain alcohol sanitizer resistance, spray buff or maintainer products should not be used on Hybrid finishes.*

## LINOLEUM CARE: RESTORATIVE MAINTENANCE

See Resilient Floor Finishing Maintenance Guide – Pages 84-91

*Special Considerations – Use strippers with pH < 10, like Ecolab's Linoleum Floor Stripper, and a blue pad. Allow adequate time for floor to dry (up to 24 hours) before applying floor finish. If using Hybrid finishes, only non-chemical removal methods (SPP) can be used.*

# LUXURY VINYL CARE: DAILY MAINTENANCE WITH AUTOMATIC SCRUBBER OR MOP/BUCKET

## EQUIPMENT REQUIRED

Treated dust mop
Damp mop (cotton or synthetic)
Mop bucket with wringer
Auto scrubber
Red pads
Wet floor signs
Proper safety equipment (goggles, gloves and appropriate footwear)

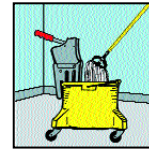
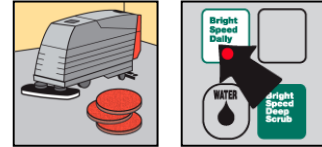

## PRODUCT REQUIRED

Product	Dilution Rate
Quik Fill 35 MAXX Dual Action Floor Cleaner	1/8-1/4 oz/gal
QC 35 MAXX Dual Action Floor Cleaner	1/4-1/2 oz/gal
Quik Fill 34 Neutral Floor Cleaner	1/2-2 oz/gal
QC 34 High Performance UC Neutral Floor Cleaner	1/4-1 oz/gal
FACILIPRO™ Alkaline Floor Cleaner	1/8-1/4 oz/gal
FACILIPRO™ Concentrated Alkaline Floor Cleaner	1/4-1/2 oz/gal
FACILIPRO™ Neutral Floor Cleaner	1/2-2 oz/gal
FACILIPRO™ Concentrated Neutral Floor Cleaner	1/4-1 oz/gal

## PROCEDURE

### Automatic Scrubber

1. Position wet floor signs. Put on proper safety equipment.
2. Use treated broom to sweep accumulated soil from the floor surface into dust pan for disposal.
3. Mix cleaning solution in the auto scrubber and mop bucket using appropriate dilution rate.
4. Position the red pad onto the auto scrubber.
5. Using the auto scrubber, apply the cleaning solution, scrub and pick up residue in one operation.
6. Mop the corners and edges manually and remove any excess solution.
7. Thoroughly clean and store all equipment and pads after use.
8. Remove wet floor signs.

### Mop and Bucket

1. Position wet floor signs. Put on proper safety equipment.
2. Use treated broom to sweep accumulated soil from the floor surface into dust pan for disposal.
3. Mix cleaning solution in the mop bucket using appropriate dilution rate per gallon of water.
4. Use a cotton or synthetic mop with cleaning solution.
5. Partially wring out mop and apply cleaning solution to approximately 10' by 10' area of floor surface. Thoroughly wring out mop in bucket and pick up excess solution.
6. Repeat step 4 until the entire floor area has been cleaned.
7. Thoroughly clean and store all equipment after use.
8. Remove wet floor signs.

## LUXURY VINYL CARE: INTERIM MAINTENANCE WITH AUTOMATIC SCRUBBER

### EQUIPMENT REQUIRED

Auto scrubber
Red pads
Wet floor signs
Proper safety equipment (goggles, gloves and appropriate footwear)

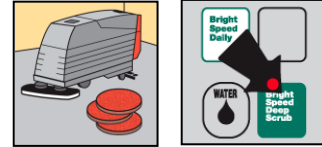

### PRODUCT REQUIRED

Product	Dilution Rate
Quik Fill 35 MAXX Dual Action Floor Cleaner	1 oz/gal
QC 35 MAXX Dual Action Floor Cleaner	2 oz/gal
FACILIPRO™ Alkaline Floor Cleaner	1 oz/gal
FACILIPRO™ Concentrated Alkaline Floor Cleaner	2 oz/gal

### PROCEDURE

#### Automatic Scrubber

1. Dust mop floor.
2. Position wet floor signs. Put on proper safety equipment.
3. Mix cleaning solution in the auto scrubber and mop bucket using appropriate dilution rate.
4. Position the red pad onto the auto scrubber.
5. Using the auto scrubber, apply the cleaning solution, scrub and pick up residue in one operation.
6. Mop the corners and edges manually and remove any excess solution not recovered by the auto scrubber.
7. Thoroughly clean and store all equipment and pads after use.
8. Remove wet floor signs.

## LUXURY VINYL CARE: RESTORATIVE MAINTENANCE

*For Luxury Vinyl Floors, See Resilient Floor Finishing Maintenance Guide – Pages 75-78.*

***Special Considerations – Use only blue or green pads for restorative work. Apply 2 coats of Vinyl and Stone Sealer prior to finish application. Ecolab product recommendation for low gloss finish – Matte Finish. If using Hybrid finishes, only non-chemical removal methods (SPP) can be used.***

# MARBLE CARE: DAILY MAINTENANCE WITH AUTOMATIC SCRUBBER OR MOP/BUCKET

## EQUIPMENT REQUIRED

Treated dust mop
Damp mop (cotton or synthetic)
Mop bucket with wringer
Auto scrubber
Red pads
Wet floor signs
Proper safety equipment (goggles, gloves and appropriate footwear)

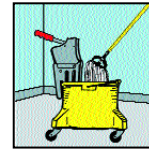
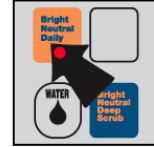
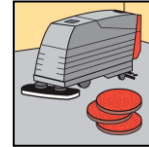

## PRODUCT REQUIRED

Product	Dilution Rate
Pinnacle Floor Cleaner/Conditioner	1-1½ oz/gal
StoneMedic DCC Daily Cleaner/Conditioner	1-1½ oz/gal
Quik Fill 34 Neutral Floor Cleaner	½-2 oz/gal
QC 34 High Performance UC Neutral Floor Cleaner	¼-1 oz/gal
FACILIPRO™ Neutral Floor Cleaner	½-2 oz/gal
FACILIPRO™ Concentrated Neutral Floor Cleaner	¼-1 oz/gal

## PROCEDURE

### Automatic Scrubber

1. Position wet floor signs. Put on proper safety equipment.
2. Use treated broom to sweep accumulated soil from the floor surface into dust pan for disposal.
3. Mix cleaning solution in the auto scrubber and mop bucket using appropriate dilution rate.
4. Position the red pad onto the auto scrubber.
5. Using the auto scrubber, apply the cleaning solution, scrub and pick up residue in one operation.
6. Mop the corners and edges manually and remove any excess solution.
7. Thoroughly clean and store all equipment and pads after use.
8. Remove wet floor signs.

### Mop and Bucket

1. Position wet floor signs. Put on proper safety equipment.
2. Use treated broom to sweep accumulated soil from the floor surface into dust pan for disposal.
3. Mix cleaning solution in the mop bucket using appropriate dilution rate per gallon of water.
4. Use a cotton or synthetic mop with cleaning solution.
5. Partially wring out mop and apply cleaning solution to approximately 10' by 10' area of floor surface. Thoroughly wring out mop in bucket and pick up excess solution.
6. Repeat step 4 until the entire floor area has been cleaned.
7. Thoroughly clean and store all equipment after use.
8. Remove wet floor signs.

# MARBLE CARE: INTERIM MAINTENANCE WITH POLISHING AND IMPREGNATION

## EQUIPMENT REQUIRED

Damp mop (cotton or synthetic)
Mop bucket or autoscrubber with red pad
Hogshair & White Pads
Mighty Max
Pump up sprayer
Wet vac
Wet floor signs
Proper safety equipment (goggles, gloves and appropriate footwear)

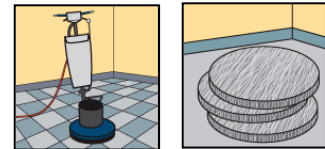
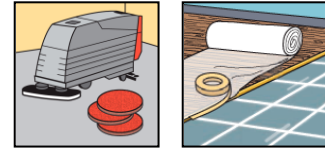

## PRODUCT REQUIRED

Product	Dilution Rate
Linoleum Floor Stripper	12 oz/gal
Pinnacle® Marble Polish Paste	RTU
Pinnacle® Grout Line Impregnator	RTU
StoneMedic® MPC Marble Polishing Compound	RTU
StoneMedic® CGI Ceramic Grout Impregnator	RTU

## PROCEDURE

### Interim Cleaning

1. Dust mop floor.
2. Position wet floor signs. Put on proper safety equipment.
3. Apply Linoleum Stripper & Intensive Stone Cleaner to the floor at the proper dilution with lukewarm water using a mop and bucket or autoscrubber.
4. Remove solution with wet vacuum/autoscrubber or mop and bucket.
5. Rinse with a fresh water solution.
6. Thoroughly clean and store all equipment and pads after use.
7. Remove wet floor signs.

### Traffic Lane Polishing

1. Position wet floor signs. Put on proper safety equipment.
2. Section off and cover areas that do not need polish.
3. Apply Marble Polish Paste to the floor and add a small amount of water.
4. Polish floor using the Mighty Max and a hogshair pad making six passes or until desired shine...
5. Remove solution with wet vacuum/autoscrubber or mop and bucket.
6. Rinse with a fresh water solution.
7. Buff with white pad once dry.
8. Thoroughly clean and store all equipment and pads after use.
9. Remove wet floor signs.



## **MARBLE CARE: INTERIM MAINTENANCE WITH POLISHING AND IMPREGNATION (CON'T)**

### **Marble Impregnation**

1. Position wet floor signs. Put on proper safety equipment.
2. Apply Impregnator to tiles with roller, pump up or electric sprayer.
3. Work product into polished tiles with deck brush or low speed machine and a white pad if floor is polished.
4. Let sit 10 minutes to absorb into grout.
5. Squeegee excess product from tiles and grout lines, crossing the tiles on a diagonal.
6. Tack up excess with a cotton towel.
7. Allow 6 – 8 hours to dry thoroughly before allowing foot traffic.
8. Thoroughly clean and store all equipment after use.
9. Remove wet floor signs.

# MARBLE CARE: RESTORATIVE MAINTENANCE WITH DIAMOND GRINDING

## EQUIPMENT REQUIRED

Mighty Max
Galaxy diamonds
White pad
Hogshair pad or Tampico brush
Wet vac
Poly protect
Wet floor signs
Proper safety equipment (goggles, gloves and appropriate footwear)

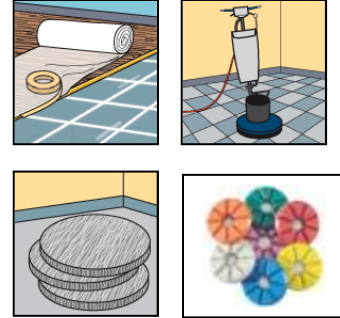

## PRODUCT REQUIRED

Product	Dilution Rate
Pinnacle® Marble Polish Paste	RTU
StoneMedic® MPC Marble Polishing Compound	RTU

## PROCEDURE

1. Position wet floor signs. Put on proper safety equipment. Place poly protect on surrounding
2. Place lowest grit Galaxy diamonds needed (for removing scratches) onto machine.
3. Add small amount of water to floor. Grind floor making six passes over the designated area or until scratches are removed and the floor is uniform (dull) in appearance.
4. Rinse with water and vacuum with wet vac.
5. Place next grit Galaxy diamonds on machine and repeat steps 3-4.
6. Increase grit until desired shine is achieved.
7. Rinse with water and vacuum with wet vac.
8. Place hogshair pad or Tampico brush onto machine.
9. Apply Marble Polish Paste to floor and add small amount of water to create a thick slurry.
10. Polish with six passes or until desired shine is achieved.
11. Rinse with fresh water and wet vac.
12. When floor is dry, place white pad onto machine and buff floor to remove residue.
13. Thoroughly clean and store all equipment after use.
14. Remove wet floor signs.

**Special Considerations:** For restoring lighter marble go to a minimum of 400 grit and darker marble to 800-1500 grit.

# QUARRY TILE CARE: DAILY MAINTENANCE WITH AUTOMATIC SCRUBBER OR MOP/BUCKET

## EQUIPMENT REQUIRED

Damp mop (cotton or synthetic)
Mop bucket with wringer
Auto scrubber
Red pads
Wet floor signs
Proper safety equipment (goggles, gloves and appropriate footwear)

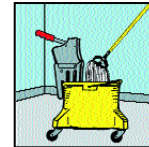
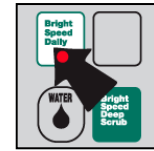
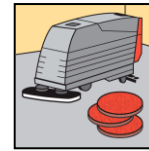

## PRODUCT REQUIRED

Product	Dilution Rate
Quik Fill 35 MAXX Dual Action Floor Cleaner	1/8-1/4 oz/gal
QC 35 MAXX Dual Action Floor Cleaner	1/4-1/2 oz/gal
Quik Fill 34 Neutral Floor Cleaner	1/2-2 oz/gal
QC 34 High Performance UC Neutral Floor Cleaner	1/4-1 oz/gal
FACILIPRO™ Alkaline Floor Cleaner	1/8-1/4 oz/gal
FACILIPRO™ Concentrated Alkaline Floor Cleaner	1/4-1/2 oz/gal
FACILIPRO™ Neutral Floor Cleaner	1/2-2 oz/gal
FACILIPRO™ Concentrated Neutral Floor Cleaner	1/4-1 oz/gal

## PROCEDURE

### Automatic Scrubber

1. Position wet floor signs. Put on proper safety equipment.
2. Use broom to sweep accumulated soil from the floor surface into dust pan for disposal.
3. Mix cleaning solution in the auto scrubber and mop bucket using appropriate dilution rate.
4. Position the red pad onto the auto scrubber.
5. Using the auto scrubber, apply the cleaning solution, scrub and pick up residue in one operation.
6. Mop the corners and edges manually and remove any excess solution not recovered by the auto scrubber.
7. Thoroughly clean and store all equipment and pads after use.
8. Remove wet floor signs.

### Mop and Bucket

1. Position wet floor signs. Put on proper safety equipment.
2. Use broom to sweep accumulated soil from the floor surface into dust pan for disposal.
3. Mix cleaning solution in the mop bucket using appropriate dilution rate per gallon of water.
4. Use a cotton or synthetic mop with cleaning solution.
5. Partially wring out mop and apply cleaning solution to approximately 10' by 10' area of floor surface. Thoroughly wring out mop in bucket and pick up excess solution from the area.
6. Repeat step 4 until the entire floor area has been cleaned.
7. Thoroughly clean and store all equipment after use.
8. Remove wet floor signs.

**Special Considerations:** *If the Quarry Tile is in a kitchen, use the procedure section for Quarry Tile (Kitchen) Care.*

## QUARRY TILE CARE: INTERIM MAINTENANCE WITH AUTOMATIC SCRUBBER

### EQUIPMENT REQUIRED

Damp mop (cotton or synthetic)
Mop bucket or autoscrubber with red pad
Deck brush
Low speed machine with brush
Wet vac
Wet floor signs
Proper safety equipment (goggles, gloves and appropriate footwear)

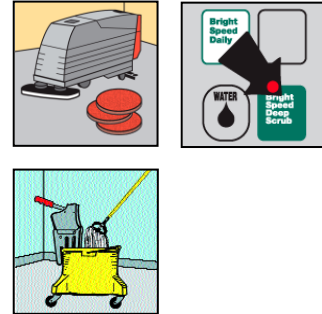

### PRODUCT REQUIRED

Product	Dilution Rate
Pinnacle <sup>®</sup> Intensive Tile Cleaner	12-64 oz/gal
StoneMedic <sup>®</sup> CIC Ceramic Intensive Cleaner	12-64 oz/gal

### PROCEDURE

#### Interim Cleaning

1. Dust mop floor.
2. Position wet floor signs. Put on proper safety equipment.
3. Apply Cleaner to the floor at the proper dilution with lukewarm water using a mop and bucket or autoscrubber.
4. Initial quick agitation with brush (low speed machine/autoscrubber with brush or deck brush).
5. Allow to dwell for 6 to 10 minutes.
6. Scrub well into grout lines with brush (low speed machine/autoscrubber with brush or deck brush).
7. Remove solution with wet vacuum/autoscrubber or mop and bucket.
8. Rinse with a fresh water solution.
9. Thoroughly clean and store all equipment and pads after use.
10. Remove wet floor signs.

**Special Considerations:** *If the Quarry Tile is in a kitchen, use the procedure section for Quarry Tile (Kitchen) Care.*

## QUARRY TILE CARE: RESTORATIVE MAINTENANCE

**For quarry tile polishing, refer to manufacturer's specifications. DO NOT POLISH QUARRY TILE IN KITCHEN APPLICATIONS.**

## QUARRY TILE (KITCHEN) CARE: DAILY MAINTENANCE WITH MOP/BUCKET

### EQUIPMENT REQUIRED

Damp mop (cotton or synthetic)
Mop bucket with wringer
Wet floor signs
Proper safety equipment (goggles, gloves and appropriate footwear)

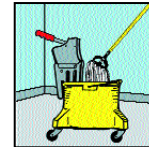
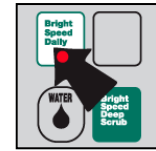
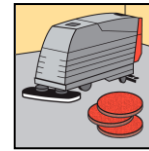

### PRODUCT REQUIRED

Product	Dilution Rate
Wash 'N Walk® No Rinse Floor Cleaner	2-4 oz/gal
Keystone Wash 'N Walk Floor Cleaner	¼-1 oz/gal

### PROCEDURE

#### Mop and Bucket

1. Position wet floor signs. Put on proper safety equipment.
2. Use broom or hose to remove debris from the floor and under counters and equipment.
3. Mix cleaning solution with **cold water** in the mop bucket using appropriate dilution rate.
4. Use a grease release mop to apply cleaning solution to floor surface, working in sections.
5. Use deck brush to scrub the floor, including the base coving.
6. Repeat steps 4-5 until the entire floor area has been cleaned.
7. Squeegee excess solution to drain.
8. **Do not rinse floor.**
9. Thoroughly clean and store all equipment after use.
10. Remove wet floor signs.

**Special Considerations:** *If the Quarry Tile is in the front of house, use the procedure section for Quarry Tile Care.*

## QUARRY TILE (KITCHEN) CARE: INTERIM MAINTENANCE WITH LOW SPEED MACHINE OR AUTOSCRUBBER

### EQUIPMENT REQUIRED

Damp mop (grease release)
Mop bucket with wringer
Swing machine
Auto scrubber
Blue or green pads or flagged brush
Wet floor signs
Proper safety equipment (goggles, gloves and appropriate footwear)

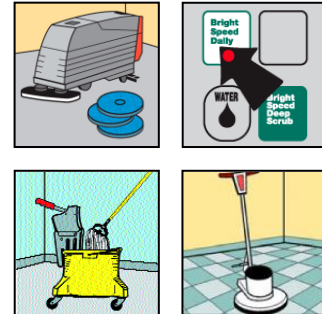

### PRODUCT REQUIRED

Product	Dilution Rate
Oasis 115XP	4 oz/gal
Keystone Floor Cleaner	4 oz/gal
MAXX Dual Action Floor Cleaner	2 oz/gal

### PROCEDURE

#### Low Speed Machine

1. Position wet floor signs. Put on proper safety equipment.
2. Use broom or hose to remove debris from the floor and under counters and equipment.
3. Mix cleaning solution with **hot water** in the mop bucket using appropriate dilution rate.
4. Position blue or green pad or flagged brush under low speed machine.
5. Use a grease release mop to apply cleaning solution to floor surface, working in sections.
6. Use low speed machine to remove heavy soil or grease buildup from the floor.
7. Repeat steps 4-5 until the entire floor area has been cleaned.
8. Rinse floor with clean, **hot water**.
9. Squeegee excess solution to drain.
10. Thoroughly clean and store all equipment after use.
11. Remove wet floor signs.

#### Autoscrubber

1. Position wet floor signs. Put on proper safety equipment.
2. Use broom or hose to remove debris from the floor and under counters and equipment.
3. Mix cleaning solution in the auto scrubber with **hot water** using appropriate dilution rate.
4. Position the blue or green pad or flagged brush onto the auto scrubber.
5. With the auto scrubber, use the "double scrub" method:
  - a. Apply the solution with the pads down, squeegee up and the vacuum off.
  - b. Make a second pass with the pads down, squeegee down and the vacuum on.
6. Mop the corners and edges manually and remove any excess solution.
7. Rinse the floor with clean water using single pass with the autoscrubber.
8. Thoroughly clean and store all equipment and pads after use.
9. Remove wet floor signs.

**Special Considerations:** *If the Quarry Tile is in the front of house, use the procedure section for Quarry Tile Care.*

## QUARRY TILE (KITCHEN) CARE: RESTORATIVE MAINTENANCE

**Special Considerations:** *DO NOT POLISH QUARRY TILE IN KITCHEN APPLICATIONS.*

# RUBBER FLOOR CARE: DAILY MAINTENANCE WITH AUTOMATIC SCRUBBER OR MOP/BUCKET

## EQUIPMENT REQUIRED

Dust mop
Damp mop (cotton or synthetic)
Mop bucket with wringer
Auto scrubber
Red pads or flagged brush
Wet floor signs
Proper safety equipment (goggles, gloves and appropriate footwear)

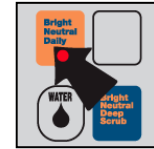
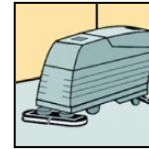

## PRODUCT REQUIRED

Product	Dilution Rate
Quik Fill 34 Neutral Floor Cleaner	1/2-2 oz/gal
QC 34 High Performance UC Neutral Floor Cleaner	1/4-1 oz/gal
FACILIPRO™ Neutral Floor Cleaner	1/2-2 oz/gal
FACILIPRO™ Concentrated Neutral Floor Cleaner	1/4-1 oz/gal

## PROCEDURE

### Automatic Scrubber

1. Position wet floor signs. Put on proper safety equipment.
2. Use broom to sweep accumulated soil from the floor surface into dust pan for disposal. **Do not use oil based dust mop sweeping solutions as they will soften the tiles.**
3. Mix cleaning solution in the auto scrubber/mop bucket using appropriate dilution rate.
4. Position the red pad onto the auto scrubber.
5. Using the auto scrubber, apply the cleaning solution, scrub and pick up residue in one operation.
6. Mop the corners and edges manually and remove any excess solution.
7. Thoroughly clean and store all equipment and pads after use.
8. Remove wet floor signs.

### Mop and Bucket

1. Position wet floor signs. Put on proper safety equipment.
2. Use broom to sweep accumulated soil from the floor surface into dust pan for disposal. **Do not use oil based dust mop sweeping solutions as they will soften the tiles.**
3. Mix cleaning solution in the mop bucket using appropriate dilution rate per gallon of water.
4. Partially wring out mop and apply cleaning solution to floor surface. Thoroughly wring out mop in bucket and pick up excess solution. Scrub heavily soiled areas with a nylon brush.
5. Repeat step 4 until the entire floor area has been cleaned.
6. Thoroughly clean and store all equipment after use.
7. Remove wet floor signs.

**Special Circumstances: Review manufacturer's guidelines for cleaning. Some softer rubber floors can only accept nylon brush or blue pad cleaning with <300 rpm machines. A higher concentration of cleaner may be needed for heavily soiled areas. Avoid flooding the floor.**

# RUBBER FLOOR CARE: INTERIM MAINTENANCE WITH AUTOMATIC SCRUBBER OR LOW SPEED MACHINE

## EQUIPMENT REQUIRED

Damp mop (cotton or synthetic)
Mop bucket with wringer
Auto scrubber
Red pads or flagged brush
Low speed machine
Wet Vac
Tampico brush
Wet floor signs
Proper safety equipment (goggles, gloves and appropriate footwear)

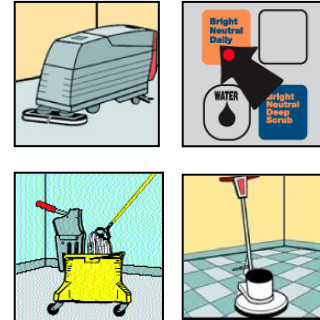

## PRODUCT REQUIRED

Product	Dilution Rate
Quik Fill 34 Neutral Floor Cleaner	2 oz/gal
QC 34 High Performance UC Neutral Floor Cleaner	1 oz/gal
FACILIPRO™ Neutral Floor Cleaner	2 oz/gal
FACILIPRO™ Concentrated Neutral Floor Cleaner	1 oz/gal

## PROCEDURE

### Automatic Scrubber

1. Position wet floor signs. Put on proper safety equipment.
2. Mix cleaning solution in the auto scrubber/mop bucket using appropriate dilution rate.
3. Position the red pad onto the auto scrubber or low speed machine.
4. With the auto scrubber, use the “double scrub” method.
  - a. Apply the solution with the pads down, squeegee up and the vacuum off.
  - b. Make a second pass with the pads down, squeegee down and vacuum on.
5. Use the “double scrub” method one area at a time.
6. Mop the corners and edges manually and remove any excess solution.
7. With the low speed machine, work in a 10'x10' section of floor.
  - a. Apply the solution with a mop and bucket. Make multiple passes over the section with the low speed machine.
  - b. Remove excess solution with the wet vac.
8. Let floor dry completely.
9. Position Tampico brush onto the low speed machine or autoscrubber..
10. Dry polish floor to desired luster
11. Thoroughly clean and store all equipment and pads after use.
12. Remove wet floor signs.

**Special Considerations – Do not use harsh chemical or solvents. Overcleaning the rubber floor will remove natural migrating waxes.**



# RUBBER FLOOR CARE: RESTORATIVE MAINTENANCE WITH AUTOMATIC SCRUBBER

## EQUIPMENT REQUIRED

Damp mop (cotton or synthetic)
Mop bucket with wringer
Auto scrubber
Red pads or flagged brush
Mop and bucket for finish
Flat mop with microfiber pad
Wet floor signs
Proper safety equipment (goggles, gloves and appropriate footwear)

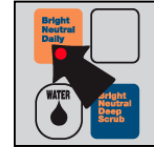
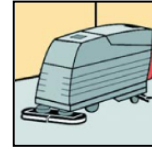

## PRODUCT REQUIRED

Product	Dilution Rate
Quik Fill 34 Neutral Floor Cleaner	2 oz/gal
QC 34 High Performance UC Neutral Floor Cleaner	1 oz/gal
FACILIPRO™ Neutral Floor Cleaner	2 oz/gal
FACILIPRO™ Concentrated Neutral Floor Cleaner	1 oz/gal
Easy Glow	2-4 oz/gal

## PROCEDURE

### Automatic Scrubber

1. Position wet floor signs. Put on proper safety equipment.
2. Mix cleaning solution in the auto scrubber/mop bucket using appropriate dilution rate.
3. Position the red pad onto the auto scrubber.
4. With the auto scrubber, use the “double scrub” method.
  - c. Apply the solution with the pads down, squeegee up and the vacuum off.
  - d. Make a second pass with the pads down, squeegee down and vacuum on.
5. Use the “double scrub” method one area at a time.
6. Mop the corners and edges manually and remove any excess solution.
7. Let floor dry completely.

### Maintainer Application

1. Mix Easy Glow solution with cold water in the mop bucket using appropriate dilution rate.
2. Start in the section farthest away from the door or wherever you need to exit.
3. Partially wring out synthetic mop and apply Easy Glow solution to the floor surface, working in sections.
4. Repeat step 3 until the entire floor area has been coated. Do not rinse.
5. Let floor dry completely.
6. Burnish as needed (see Resilient Floor Finishing Maintenance Guide – Page 82).
7. Thoroughly clean and store all equipment after use.
8. Remove wet floor signs.

**Special Considerations – Apply only one coat of finish. The natural waxes will migrate to the surface in 30 days as the finish is walked off.**

# RUBBER (RECYCLED - NON-FINISHED) CARE: DAILY MAINTENANCE WITH AUTOMATIC SCRUBBER AND MOP/BUCKET

## EQUIPMENT REQUIRED

Dust mop
Damp mop (cotton or synthetic)
Mop bucket with wringer
Auto scrubber
Red pads or nylon brush
Wet floor signs
Proper safety equipment (goggles, gloves and appropriate footwear)

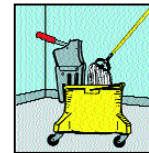
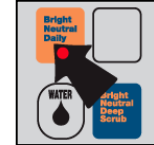
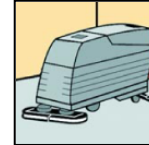

## PRODUCT REQUIRED

Product	Dilution Rate
Quik Fill 34 Neutral Floor Cleaner	½-2 oz/gal
QC 34 High Performance UC Neutral Floor Cleaner	¼-1 oz/gal
FACILIPRO™ Neutral Floor Cleaner	½-2 oz/gal
FACILIPRO™ Concentrated Neutral Floor Cleaner	¼-1 oz/gal

## PROCEDURE

### Automatic Scrubber

1. Position wet floor signs. Put on proper safety equipment.
2. Use broom to sweep accumulated soil from the floor surface into dust pan for disposal. **Do not use oil based dust mop sweeping solutions as they will soften the tiles.**
3. Mix cleaning solution in the auto scrubber/mop bucket using appropriate dilution rate.
4. Position the purple pad onto the auto scrubber.
5. Using the auto scrubber, apply the cleaning solution, scrub and pick up residue in one operation.
6. Mop the corners and edges manually and remove any excess solution.
7. Thoroughly clean and store all equipment and pads after use.
8. Remove wet floor signs.

### Mop and Bucket

1. Position wet floor signs. Put on proper safety equipment.
2. Use broom to sweep accumulated soil from the floor surface into dust pan for disposal. **Do not use oil based dust mop sweeping solutions as they will soften the tiles.**
3. Mix cleaning solution in the mop bucket using appropriate dilution rate per gallon of water.
4. Partially wring out mop and apply cleaning solution to floor surface. Thoroughly wring out mop in bucket and pick up excess solution. Scrub heavily soiled areas with a nylon brush.
5. Repeat step 4 until the entire floor area has been cleaned.
6. Thoroughly clean and store all equipment after use.
7. Remove wet floor signs.

**Special Circumstances: Review manufacturer's guidelines for cleaning. Some softer rubber floors can only accept nylon brush or blue pad cleaning with <300 rpm machines. A higher concentration of cleaner may be needed for heavily soiled areas. Avoid flooding the floor.**

# RUBBER (RECYCLED - FINISHED) CARE: DAILY MAINTENANCE WITH AUTO SCRUBBER AND MOP/BUCKET

## EQUIPMENT REQUIRED

Treated dust mop
Damp mop (cotton or synthetic)
Mop bucket with wringer
Auto scrubber
Red pad or nylon brush
Wet floor signs
Proper safety equipment (goggles, gloves and appropriate footwear)

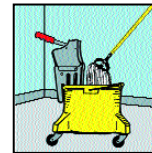
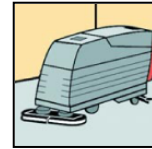

## PRODUCT REQUIRED

Product	Dilution Rate
Quik Fill 34 Neutral Floor Cleaner	½-2 oz/gal
QC 34 High Performance UC Neutral Floor Cleaner	¼-1 oz/gal
FACILIPRO™ Neutral Floor Cleaner	½-2 oz/gal
FACILIPRO™ Concentrated Neutral Floor Cleaner	¼-1 oz/gal

## PROCEDURE

### Automatic Scrubber

1. Position wet floor signs. Put on proper safety equipment.
2. Use treated broom to sweep accumulated soil from the floor surface into dust pan for disposal.
3. Mix cleaning solution in the auto scrubber and mop bucket using appropriate dilution rate.
4. Position the nylon brush onto the auto scrubber.
5. Using the auto scrubber, apply the cleaning solution, scrub and pick up residue in one operation.
6. Mop the corners and edges manually and remove any excess solution.
7. Thoroughly clean and store all equipment and pads after use.
8. Remove wet floor signs.
9. Burnish as needed (see Resilient Floor Finishing Maintenance Guide – Page 82).

### Mop and Bucket

1. Position wet floor signs. Put on proper safety equipment.
2. Use treated broom to sweep accumulated soil from the floor surface into dust pan for disposal.
3. Mix cleaning solution in the mop bucket using appropriate dilution rate per gallon of water.
4. Use a cotton or synthetic mop with cleaning solution.
5. Partially wring out mop and apply cleaning solution to approximately 10' by 10' area. Thoroughly wring out mop and pick up excess solution. Scrub heavily soiled areas with a nylon brush.
6. Repeat step 4 until the entire floor area has been cleaned.
7. Thoroughly clean and store all equipment after use.
8. Remove wet floor signs.
9. Burnish as needed (see Resilient Floor Finishing Maintenance Guide – Page 82).

**Special Circumstances: Review manufacturer's guidelines for cleaning. When cleaning floors with an applied finish, use only a microfiber mop and nylon brush. Purple pads will remove floor finish. Avoid flooding the floor. If disinfection of finished floors is required, use Hybrid finishes to prevent stickiness from quats.**

## **RUBBER (RECYCLED - FINISHED) CARE: INTERIM MAINTENANCE**

See Resilient Floor Finishing Maintenance Guide – Page 83

*Special Considerations – Consult manufacturer’s guidelines for scrub and recoat. Allow floor to dry completely after scrubbing before applying finish. To maintain alcohol sanitizer resistance, spray buff or maintainer products should not be used on Hybrid finishes.*

## **RUBBER (RECYCLED - FINISHED) CARE: RESTORATIVE MAINTENANCE**

See Resilient Floor Finishing Maintenance Guide – Pages 84-91

*Special Considerations – Consult manufacturer’s guidelines for stripping. Some softer rubber may require strippers with pH < 10, like Ecolab’s Linoleum Floor Finish Remover, and lower speed machines (<300 rpm). Allow floor to dry completely after stripping before applying finish. If using Hybrid finishes, only non-chemical removal methods (SPP) can be used.*

# SLATE TILE CARE: DAILY MAINTENANCE WITH AUTOMATIC SCRUBBER OR MOP/BUCKET

## EQUIPMENT REQUIRED

Treated dust mop
Damp mop (cotton or synthetic)
Mop bucket with wringer
Auto scrubber
Nylon brush or deck brush
Wet floor signs
Proper safety equipment (goggles, gloves and appropriate footwear)

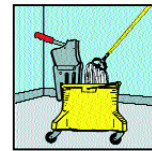
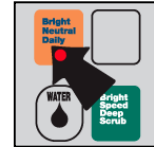
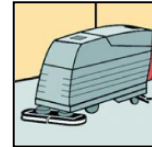

## PRODUCT REQUIRED

Product	Dilution Rate
Quik Fill 35 MAXX Dual Action Floor Cleaner	$\frac{1}{8}$ - $\frac{1}{4}$ oz/gal
QC 35 MAXX Dual Action Floor Cleaner	$\frac{1}{4}$ - $\frac{1}{2}$ oz/gal
Quik Fill 34 Neutral Floor Cleaner	$\frac{1}{2}$ -2 oz/gal
QC 34 High Performance UC Neutral Floor Cleaner	$\frac{1}{4}$ -1 oz/gal
FACILIPRO™ Alkaline Floor Cleaner	$\frac{1}{8}$ - $\frac{1}{4}$ oz/gal
FACILIPRO™ Concentrated Alkaline Floor Cleaner	$\frac{1}{4}$ - $\frac{1}{2}$ oz/gal
FACILIPRO™ Neutral Floor Cleaner	$\frac{1}{2}$ -2 oz/gal
FACILIPRO™ Concentrated Neutral Floor Cleaner	$\frac{1}{4}$ -1 oz/gal

## PROCEDURE

### Automatic Scrubber

1. Position wet floor signs. Put on proper safety equipment.
2. Use treated broom to sweep accumulated soil from the floor surface into dust pan for disposal.
3. Mix cleaning solution in the auto scrubber and mop bucket using appropriate dilution rate.
4. Position the nylon brush onto the auto scrubber.
5. Using the auto scrubber, apply the cleaning solution, scrub and pick up residue in one operation.
6. Mop the corners and edges manually and remove any excess solution not recovered by the auto scrubber.
7. Thoroughly clean and store all equipment and pads after use.
8. Remove wet floor signs.

### Mop and Bucket

1. Position wet floor signs. Put on proper safety equipment.
2. Use treated broom to sweep accumulated soil from the floor surface into dust pan for disposal.
3. Mix cleaning solution in the mop bucket using appropriate dilution rate per gallon of water.
4. Use a cotton or synthetic mop with cleaning solution.
5. Partially wring out mop and apply cleaning solution to approximately 10' by 10' area of floor surface. Scrub heavily soiled areas with a deck brush. Thoroughly wring out mop in bucket and pick up excess solution from the area.
6. Repeat step 4 until the entire floor area has been cleaned.
7. Thoroughly clean and store all equipment after use.
8. Remove wet floor signs.

# SLATE TILE CARE: INTERIM MAINTENANCE WITH IMPREGNATION

## EQUIPMENT REQUIRED

Damp mop (cotton or synthetic)
Mop bucket or autoscrubber with nylon brush
Deck brush
Low speed machine with brush
Wet vac
Pump up sprayer
Wet floor signs
Proper safety equipment (goggles, gloves and appropriate footwear)

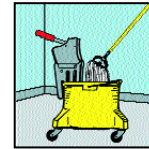
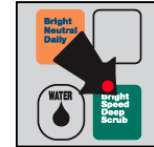

## PRODUCT REQUIRED

Product	Dilution Rate
Quik Fill 35 MAXX Dual Action Cleaner	1 oz/gal
QC 35 MAXX Dual Action Floor Cleaner	2 oz/gal
Pinnacle® Grout Line Impregnator	RTU
FACILIPRO™ Alkaline Floor Cleaner	1 oz/gal
FACILIPRO™ Concentrated Alkaline Floor Cleaner	2 oz/gal
StoneMedic™ CGI Ceramic Grout Impregnator	RTU

## PROCEDURE

### Interim Cleaning

1. Dust mop floor.
2. Position wet floor signs. Put on proper safety equipment.
3. Mix cleaning solution in the auto scrubber and mop bucket using appropriate dilution rate.
4. Position the nylon brush onto the auto scrubber.
5. Using the auto scrubber, apply the cleaning solution, scrub and pick up residue in one operation.
6. Mop the corners and edges manually and remove any excess solution.
7. Thoroughly clean and store all equipment and pads after use.
8. Remove wet floor signs.

### Slate Impregnation

1. Position wet floor signs. Put on proper safety equipment.
2. Apply Impregnator to slate with roller or sprayer.
3. Work product into slate with deck brush or low speed machine and a white pad.
4. Let sit 10 minutes to absorb into floor.
5. Squeegee excess product and tack up excess with a cotton towel.
6. Allow 6 – 8 hours to dry thoroughly before allowing foot traffic.
7. Thoroughly clean and store all equipment after use.
8. Remove wet floor signs.

## SLATE TILE CARE: RESTORATIVE MAINTENANCE

For slate restoration, refer to manufacturer's specifications.

## STATIC CONDUCTIVE/DISSIPATIVE (ESD) FLOOR CARE: DAILY MAINTENANCE WITH AUTO SCRUBBER OR MOP/BUCKET

### EQUIPMENT REQUIRED

Dust mop
Damp mop (cotton or synthetic)
Mop bucket with wringer
Auto scrubber
Red pads
Wet floor signs
Proper safety equipment (goggles, gloves and appropriate footwear)

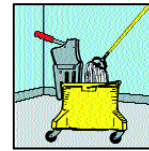
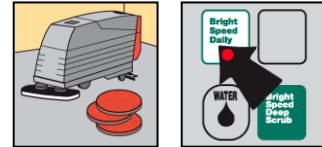

### PRODUCT REQUIRED

**Requires specialized chemicals –  
No Ecolab offering at this time**

#### Automatic Scrubber

1. Position wet floor signs. Put on proper safety equipment.
2. Use broom to sweep accumulated soil from the floor surface into dust pan for disposal.
3. Test floors with a surface resistivity meter according to ANSI/ESD STM7.1-2005 specifications.
4. Mix cleaning solution in the auto scrubber and mop bucket using appropriate dilution rate.
5. Position the red pad onto the auto scrubber.
6. Using the auto scrubber, apply the cleaning solution, scrub and pick up residue in one operation.
7. Mop the corners and edges manually and remove any excess solution.
8. Allow floor to dry thoroughly and retest floor with a surface resistivity meter according to ANSI/ESD STM7.1-2005 specifications.
9. Thoroughly clean and store all equipment and pads after use.
10. Remove wet floor signs.

#### Mop and Bucket

1. Position wet floor signs. Put on proper safety equipment.
2. Use broom to sweep accumulated soil from the floor surface into dust pan for disposal.
3. Test floor with a surface resistivity meter according to ANSI/ESD STM7.1-2005 specifications.
4. Mix cleaning solution in the mop bucket using appropriate dilution rate per gallon of water.
5. Use a cotton or synthetic mop with cleaning solution.
6. Partially wring out mop and apply cleaning solution to floor surface. Thoroughly wring out mop in bucket and pick up excess solution.
7. Repeat step 4 until the entire floor area has been cleaned.
8. Allow floor to dry thoroughly and retest floor with a surface resistivity meter according to ANSI/ESD STM7.1-2005 specifications.
9. Thoroughly clean and store all equipment after use.
10. Remove wet floor signs.

**Special Considerations – Consult manufacturer’s guidelines for maintenance. Floor requires ESD certified cleaners, strippers and finishes.**

## STATIC CONDUCTIVE/DISSIPATIVE (ESD) FLOOR CARE: INTERIM MAINTENANCE WITH AUTOMATIC SCRUBBER

### EQUIPMENT REQUIRED

Auto scrubber
Red pads
Wet floor signs
Proper safety equipment (goggles, gloves and appropriate footwear)

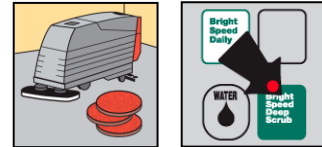

### PRODUCT REQUIRED

**Requires specialized chemicals –  
No Ecolab offering at this time**

### Automatic Scrubber

1. Dust mop floor.
2. Position wet floor signs. Put on proper safety equipment.
3. Mix cleaning solution in the auto scrubber and mop bucket using appropriate dilution rate.
4. Position the red pad onto the auto scrubber.
5. Using the auto scrubber, apply the cleaning solution, scrub and pick up residue in one operation.
6. Mop the corners and edges manually and remove any excess solution.
7. Thoroughly clean and store all equipment and pads after use.
8. Remove wet floor signs.
9. Burnish as needed (see Resilient Floor Finishing Maintenance Guide – Page 82).

*Special Considerations – Consult manufacturer's guidelines for maintenance. Floor requires ESD certified cleaners, strippers and finishes.*

## STATIC CONDUCTIVE/DISSIPATIVE (ESD) FLOOR CARE: RESTORATIVE MAINTENANCE

For ESD Floors, See Resilient Floor Finishing Maintenance Guide – Page 83-77

*Special Considerations – Consult manufacturer's guidelines for maintenance. Floor requires ESD certified cleaners, strippers and finishes.*



## SYNTHETIC SPORT FLOOR (MODULAR AND PERMANENT) CARE: DAILY MAINTENANCE WITH AUTOMATIC SCRUBBER OR MOP/BUCKET

### EQUIPMENT REQUIRED

Treated dust mop
Damp mop (cotton or synthetic)
Mop bucket with wringer
Auto scrubber
Red pads
Wet floor signs
Proper safety equipment (goggles, gloves and appropriate footwear)

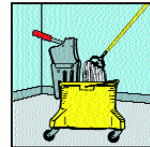
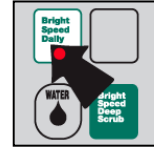
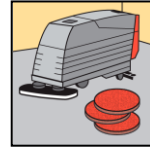

### PRODUCT REQUIRED

Product	Dilution Rate
Quik Fill 35 MAXX Dual Action Floor Cleaner	1/8-1/4 oz/gal
QC 35 MAXX Dual Action Floor Cleaner	1/4-1/2 oz/gal
Quik Fill 34 Neutral Floor Cleaner	1/2-2 oz/gal
QC 34 High Performance UC Neutral Floor Cleaner	1/4-1 oz/gal
FACILIPRO™ Alkaline Floor Cleaner	1/8-1/4 oz/gal
FACILIPRO™ Concentrated Alkaline Floor Cleaner	1/4-1/2 oz/gal
FACILIPRO™ Neutral Floor Cleaner	1/2-2 oz/gal
FACILIPRO™ Concentrated Neutral Floor Cleaner	1/4-1 oz/gal

### PROCEDURE

#### Automatic Scrubber

1. Position wet floor signs. Put on proper safety equipment.
2. Use treated broom to sweep accumulated soil from the floor surface into dust pan for disposal.
3. Mix cleaning solution in the auto scrubber and mop bucket using appropriate dilution rate.
4. Position the red pad onto the auto scrubber.
5. Using the auto scrubber, apply the cleaning solution, scrub and pick up residue in one operation.
6. Mop the corners and edges manually and remove any excess solution.
7. Thoroughly clean and store all equipment and pads after use.
8. Remove wet floor signs.

#### Mop and Bucket

1. Position wet floor signs. Put on proper safety equipment.
2. Use treated broom to sweep accumulated soil from the floor surface into dust pan for disposal.
3. Mix cleaning solution in the mop bucket using appropriate dilution rate per gallon of water.
4. Use a cotton or synthetic mop with cleaning solution.
5. Partially wring out mop and apply cleaning solution to floor surface. Thoroughly wring out mop in bucket and pick up excess solution.
6. Repeat step 4 until the entire floor area has been cleaned.
7. Thoroughly clean and store all equipment after use.
8. Remove wet floor signs.

**Special Considerations – Consult manufacturer's guidelines for maintenance. Do not flood modular floor system.**

## SYNTHETIC SPORT FLOOR (MODULAR AND PERMANENT) CARE: INTERIM MAINTENANCE WITH AUTOMATIC SCRUBBER

### EQUIPMENT REQUIRED

Auto scrubber
Red pads
Wet floor signs
Proper safety equipment (goggles, gloves and appropriate footwear)

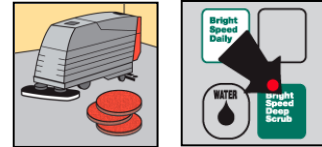

### PRODUCT REQUIRED

Product	Dilution Rate
Quik Fill 35 MAXX Dual Action Floor Cleaner	1 oz/gal
QC 35 MAXX Dual Action Floor Cleaner	2 oz/gal
FACILIPRO™ Alkaline Floor Cleaner	1 oz/gal
FACILIPRO™ Concentrated Alkaline Floor Cleaner	2 oz/gal

### PROCEDURE

#### Automatic Scrubber

1. Position wet floor signs. Put on proper safety equipment.
2. Mix cleaning solution in the auto scrubber and mop bucket using appropriate dilution rate.
3. Position the red pad onto the auto scrubber.
4. Using the auto scrubber, apply the cleaning solution, scrub and pick up residue in one operation.
5. Mop the corners and edges manually and remove any excess solution not recovered by the auto scrubber.
6. Thoroughly clean and store all equipment and pads after use.
7. Remove wet floor signs.

***Special Considerations – Consult manufacturer’s guidelines for maintenance. Do not flood modular floor system. Allow floor to dry completely after scrubbing before applying finish.***

## SYNTHETIC SPORT FLOOR (PERMANENT) CARE: RESTORATIVE MAINTENANCE

For Permanent Floors, See Resilient Floor Finishing Maintenance Guide – Pages 84-91

***Special Considerations – Ecolab product suggestion is Syntha-Seal for rubber floors. Allow floor to dry completely after stripping before applying finish.***

# TERRAZZO (CEMENT) CARE: DAILY MAINTENANCE WITH AUTOMATIC SCRUBBER AND MOP/BUCKET

## EQUIPMENT REQUIRED

Treated dust mop
Damp mop (cotton or synthetic)
Mop bucket with wringer
Auto scrubber
Red pads
Wet floor signs
Proper safety equipment (goggles, gloves and appropriate footwear)

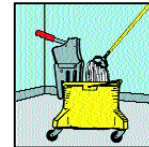
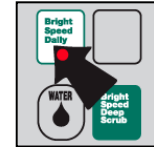
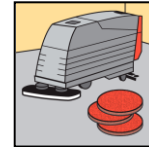

## PRODUCT REQUIRED

Product	Dilution Rate
Quik Fill 35 MAXX Dual Action Floor Cleaner	$\frac{1}{8}$ - $\frac{1}{4}$ oz/gal
QC 35 MAXX Dual Action Floor Cleaner	$\frac{1}{4}$ - $\frac{1}{2}$ oz/gal
Quik Fill 34 Neutral Floor Cleaner	$\frac{1}{2}$ -2 oz/gal
QC 34 High Performance UC Neutral Floor Cleaner	$\frac{1}{4}$ -1 oz/gal
FACILIPRO™ Alkaline Floor Cleaner	$\frac{1}{8}$ - $\frac{1}{4}$ oz/gal
FACILIPRO™ Concentrated Alkaline Floor Cleaner	$\frac{1}{4}$ - $\frac{1}{2}$ oz/gal
FACILIPRO™ Neutral Floor Cleaner	$\frac{1}{2}$ -2 oz/gal
FACILIPRO™ Concentrated Neutral Floor Cleaner	$\frac{1}{4}$ -1 oz/gal

## PROCEDURE

### Automatic Scrubber

1. Position wet floor signs. Put on proper safety equipment.
2. Use treated broom to sweep accumulated soil from the floor surface into dust pan for disposal.
3. Mix cleaning solution in the auto scrubber and mop bucket using appropriate dilution rate.
4. Position the red pad onto the auto scrubber.
5. Using the auto scrubber, apply the cleaning solution, scrub and pick up residue in one operation.
6. Mop the corners and edges manually and remove any excess solution.
7. Thoroughly clean and store all equipment and pads after use.
8. Remove wet floor signs.

### Mop and Bucket

1. Position wet floor signs. Put on proper safety equipment.
2. Use treated broom to sweep accumulated soil from the floor surface into dust pan for disposal.
3. Mix cleaning solution in the mop bucket using appropriate dilution rate per gallon of water.
4. Use a cotton or synthetic mop with cleaning solution.
5. Partially wring out mop and apply cleaning solution to approximately 10' by 10' area of floor surface. Thoroughly wring out mop in bucket and pick up excess solution.
6. Repeat step 4 until the entire floor area has been cleaned.
7. Thoroughly clean and store all equipment after use.
8. Remove wet floor signs.

# TERRAZZO (CEMENT) CARE: INTERIM MAINTENANCE WITH POLISHING AND IMPREGNATION

## EQUIPMENT REQUIRED

Damp mop (cotton or synthetic)
Mop bucket or autoscrubber with red pad
Deck brush
Mighty Max
Hogshair and white pads
#0 Steel wool pad
Wet vac
Wet floor signs
Proper safety equipment (goggles, gloves and appropriate footwear)

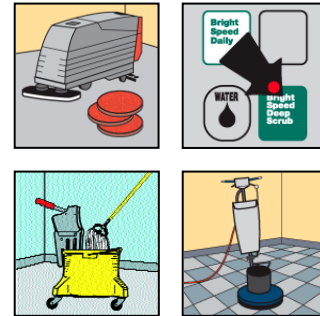

## PRODUCT REQUIRED

Product	Dilution Rate
Quik Fill 35 MAXX Dual Action Floor Cleaner	1 oz/gal
QC 35 MAXX Dual Action Floor Cleaner	2 oz/gal
Pinnacle® MPP Marble Polishing Paste	RTU
Pinnacle® MTC Marble & Terrazzo Crystallizer	RTU
Pinnacle® GLI Grout Line Impregnator	RTU
FACILIPRO Alkaline Floor Cleaner	1 oz/gal
FACILIPRO Concentrated Alkaline Floor Cleaner	2 oz/gal
StoneMedic™ MPC Marble Polishing Compound	RTU
StoneMedic™ TMC Terrazzo & Marble Crystallizer	RTU
StoneMedic™ CGI Ceramic Grout Impregnator	RTU

## PROCEDURE

### Interim Cleaning

1. Position wet floor signs. Put on proper safety equipment.
2. Mix cleaning solution in the auto scrubber and mop bucket using appropriate dilution rate per gallon of water.
3. Position the red pad onto the auto scrubber.
4. Using the auto scrubber, apply the cleaning solution, scrub and pick up residue in one operation.
5. Mop the corners and edges manually and remove any excess solution not recovered by the auto scrubber.
6. Thoroughly clean and store all equipment and pads after use.
7. Remove wet floor signs.

---

## **TERRAZZO (CEMENT) CARE: INTERIM MAINTENANCE WITH POLISHING AND IMPREGNATION (CON'T)**

### **Traffic Lane Polishing**

1. Position wet floor signs. Put on proper safety equipment.
2. Section off and cover areas that do not need polish.
3. Apply Marble Polish Paste to the floor and add a small amount of water.
4. Polish floor using the Mighty Max and a hogshair pad with six passes or until desired shine is achieved.
5. Remove solution with wet vacuum/autoscrubber or mop and bucket.
6. Rinse with a fresh water solution.
7. Buff with white pad once dry.
8. If a higher shine or added depth of color is desired, allow floor to dry for 24 hours and apply Marble & Terrazzo Crystallizer by lightly misting a spot on the floor and immediately running the floor machine (with #0 steel wool pad) over the surface.
9. Thoroughly clean and store all equipment and pads after use.
10. Remove wet floor signs.

### **Terrazzo Impregnation**

1. Position wet floor signs. Put on proper safety equipment.
2. Apply Impregnator to tiles with roller, pump up or electric sprayer.
3. Work product into polished tiles with deck brush or low speed machine and a white pad.
4. Let sit 10 minutes to absorb into grout.
5. Squeegee excess product from tiles and grout lines, crossing the tiles on a diagonal.
6. Tack up excess with a cotton towel.
7. Allow 6 – 8 hours to dry thoroughly before allowing foot traffic.
8. Thoroughly clean and store all equipment after use.
9. Remove wet floor signs.

# TERRAZZO (CEMENT) CARE: RESTORATIVE MAINTENANCE WITH DIAMOND GRINDING

## EQUIPMENT REQUIRED

Mighty Max
Galaxy diamonds
White pad
Hogshair pad or Tampico brush
#0 Steel wool pad
Wet vac
Poly protect
Wet floor signs
Proper safety equipment (goggles, gloves and appropriate footwear)

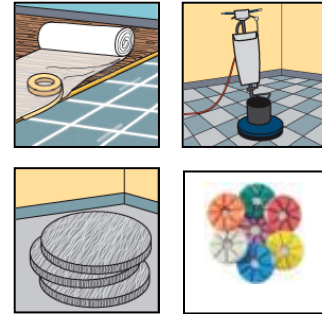

## PRODUCT REQUIRED

Product	Dilution Rate
Pinnacle® MPP Marble Polish Paste	RTU
StoneMedic™ MPC Marble Polishing Compound	RTU

## PROCEDURE

1. Position wet floor signs. Put on proper safety equipment. Place poly protect on surrounding
2. Place lowest grit Galaxy diamonds needed (for removing scratches) onto machine.
3. Add small amount of water to floor. Grind floor making six passes over the designated area or until scratches are removed and the floor is uniform (dull) in appearance.
4. Rinse with water and vacuum with wet vac.
5. Place next grit Galaxy diamonds on machine and repeat steps 3-4.
6. Increase grit until desired shine is achieved.
7. Rinse with water and vacuum with wet vac.
8. Place hogs hair pad or Tampico brush onto machine.
9. Apply Pinnacle® Marble Polish Paste to floor and add small amount of water to create a thick slurry.
10. Polish with six passes or until desired shine is achieved.
11. Rinse with fresh water and wet vac.
12. When floor is dry, place white pad onto machine and buff floor to remove residue.
13. If a higher shine or added depth of color is desired, allow floor to dry for 24 hours and apply Marble & Terrazzo Crystallizer by lightly misting a spot on the floor and immediately running the floor machine (with #0 steel wool pad) over the surface.
14. Thoroughly clean and store all equipment after use.
15. Remove wet floor signs.

# TERRAZZO (EPOXY) CARE: DAILY MAINTENANCE WITH AUTOMATIC SCRUBBER AND MOP/BUCKET

## EQUIPMENT REQUIRED

Treated dust mop
Damp mop (cotton or synthetic)
Mop bucket with wringer
Auto scrubber
Red pads
Wet floor signs
Proper safety equipment (goggles, gloves and appropriate footwear)

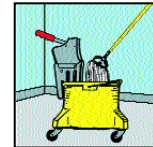
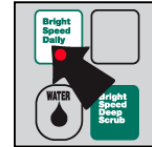
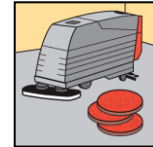

## PRODUCT REQUIRED

Product	Dilution Rate
Quik Fill 35 MAXX Dual Action Floor Cleaner	1/8-1/4 oz/gal
QC 35 MAXX Dual Action Floor Cleaner	1/4-1/2 oz/gal
Quik Fill 34 Neutral Floor Cleaner	1/2-2 oz/gal
QC 34 High Performance UC Neutral Floor Cleaner	1/4-1 oz/gal
FACILIPRO™ Alkaline Floor Cleaner	1/8-1/4 oz/gal
FACILIPRO™ Concentrated Alkaline Floor Cleaner	1/4-1/2 oz/gal
FACILIPRO™ Neutral Floor Cleaner	1/2-2 oz/gal
FACILIPRO™ Concentrated Neutral Floor Cleaner	1/4-1 oz/gal

## PROCEDURE

### Automatic Scrubber

1. Position wet floor signs. Put on proper safety equipment.
2. Use treated broom to sweep accumulated soil from the floor surface into dust pan for disposal.
3. Mix cleaning solution in the auto scrubber and mop bucket using appropriate dilution rate.
4. Position the red pad onto the auto scrubber.
5. Using the auto scrubber, apply the cleaning solution, scrub and pick up residue in one operation.
6. Mop the corners and edges manually and remove any excess solution not recovered by the auto scrubber.
7. Thoroughly clean and store all equipment and pads after use.
8. Remove wet floor signs.

### Mop and Bucket

1. Position wet floor signs. Put on proper safety equipment.
2. Use treated broom to sweep accumulated soil from the floor surface into dust pan for disposal.
3. Mix cleaning solution in the mop bucket using appropriate dilution rate per gallon of water.
4. Use a cotton or synthetic mop with cleaning solution.
5. Partially wring out mop and apply cleaning solution to approximately 10' by 10' area of floor surface. Thoroughly wring out mop in bucket and pick up excess solution from the area.
6. Repeat step 4 until the entire floor area has been cleaned.
7. Thoroughly clean and store all equipment after use.
8. Remove wet floor signs.

# TERRAZZO (EPOXY) CARE: INTERIM MAINTENANCE WITH AUTOSCRUBBER

## EQUIPMENT REQUIRED

Damp mop (cotton or synthetic)
Mop bucket or autoscrubber with red pad
Deck brush
Wet vac
Wet floor signs
Proper safety equipment (goggles, gloves and appropriate footwear)

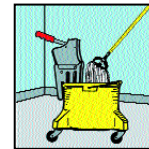
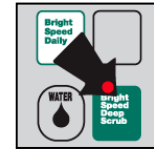
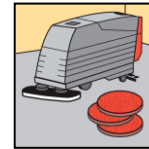

## PRODUCT REQUIRED

Product	Dilution Rate
Quik Fill 35 MAXX Dual Action Floor Cleaner	1 oz/gal
QC 35 MAXX Dual Action Floor Cleaner	2 oz/gal
FACILIPRO™ Alkaline Floor Cleaner	1 oz/gal
FACILIPRO™ Concentrated Alkaline Floor Cleaner	2 oz/gal

## PROCEDURE

### Interim Cleaning

1. Dust mop floor.
2. Position wet floor signs. Put on proper safety equipment.
3. Mix cleaning solution in the auto scrubber and mop bucket using appropriate dilution rate per gallon of water.
4. Position the red pad onto the auto scrubber.
5. Using the auto scrubber, apply the cleaning solution, scrub and pick up residue in one operation.
6. Mop the corners and edges manually and remove any excess solution not recovered by the auto scrubber.
7. Thoroughly clean and store all equipment and pads after use.
8. Remove wet floor signs.



# TERRAZZO (EPOXY) CARE: RESTORATIVE MAINTENANCE WITH POLISH

## EQUIPMENT REQUIRED

Synthetic, looped end mop
Mighty Max Floor Machine (fully loaded)
Mop bucket w/wringer
Turbo diamonds
Hogshair pad
Wet vac
Poly protect
Wet floor signs
Proper safety equipment (goggles, gloves and appropriate footwear)

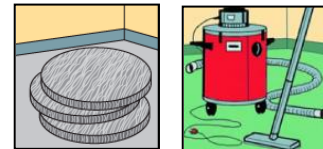
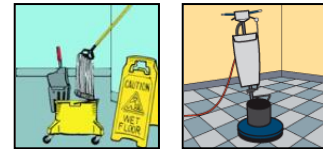

## PRODUCT REQUIRED

Product	Dilution Rate
Pinnacle® Tile Polish #2	RTU
StoneMedic CTP-2 Tile Polish #2	RTU

## PROCEDURE

### Restorative Polishing

1. Position wet floor signs. Put on proper safety equipment. Place poly protect on surrounding
2. Place lowest grit Turbo diamonds needed (for removing scratches )onto machine.
3. Add small amount of water to floor. Grind floor making six passes over the designated area or until scratches are removed and the floor is uniform (dull) in appearance.
4. Rinse with water and vacuum with wet vac.
5. Place next grit Turbo diamonds on machine and repeat steps 3-4.
6. Increase grit until desired shine is achieved.
7. Rinse with water and vacuum with wet vac.
8. Place hogshair pad onto machine.
9. Apply CTP-2 to floor and add small amount of water to create thick slurry.
10. Polish until slurry dries and desired shine achieved. Repeat if necessary for desired shine.
11. Rinse with fresh water and wet vac.
12. When floor is dry, place white pad onto machine and buff floor to remove residue.
13. Thoroughly clean and store all equipment and pads after use.
14. Remove wet floor signs.

# TERRAZZO (FINISHED) CARE: DAILY MAINTENANCE WITH AUTOMATIC SCRUBBER OR MOP/BUCKET

## EQUIPMENT REQUIRED

Treated dust mop
Damp mop (cotton or synthetic)
Mop bucket with wringer
Auto scrubber
Red pads
Wet floor signs
Proper safety equipment (goggles, gloves and appropriate footwear)

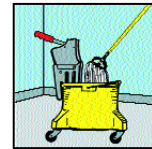
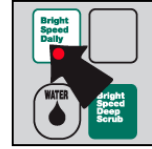
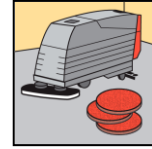

## PRODUCT REQUIRED

Product	Dilution Rate
Quik Fill 35 MAXX Dual Action Floor Cleaner	$\frac{1}{8}$ - $\frac{1}{4}$ oz/gal
QC 35 MAXX Dual Action Floor Cleaner	$\frac{1}{4}$ - $\frac{1}{2}$ oz/gal
Quik Fill 34 Neutral Floor Cleaner	$\frac{1}{2}$ -2 oz/gal
QC 34 High Performance UC Neutral Floor Cleaner	$\frac{1}{4}$ -1 oz/gal
FACILIPRO™ Alkaline Floor Cleaner	$\frac{1}{8}$ - $\frac{1}{4}$ oz/gal
FACILIPRO™ Concentrated Alkaline Floor Cleaner	$\frac{1}{4}$ - $\frac{1}{2}$ oz/gal
FACILIPRO™ Neutral Floor Cleaner	$\frac{1}{2}$ -2 oz/gal
FACILIPRO™ Concentrated Neutral Floor Cleaner	$\frac{1}{4}$ -1 oz/gal

## PROCEDURE

### Automatic Scrubber

1. Position wet floor signs. Put on proper safety equipment.
2. Use treated broom to sweep accumulated soil from the floor surface into dust pan for disposal.
3. Mix cleaning solution in the auto scrubber and mop bucket using appropriate dilution rate.
4. Position the red pad onto the auto scrubber.
5. Using the auto scrubber, apply the cleaning solution, scrub and pick up residue in one operation.
6. Mop the corners and edges manually and remove any excess solution.
7. Thoroughly clean and store all equipment and pads after use.
8. Remove wet floor signs.
9. Burnish as needed (see Resilient Floor Finishing - Maintenance Guide Page 82).

### Mop and Bucket

1. Position wet floor signs. Put on proper safety equipment.
2. Use treated broom to sweep accumulated soil from the floor surface into dust pan for disposal.
3. Mix cleaning solution in the mop bucket using appropriate dilution rate per gallon of water.
4. Use a cotton or synthetic mop with cleaning solution.
5. Partially wring out mop and apply cleaning solution to approximately 10' by 10' area of floor surface. Thoroughly wring out mop and pick up excess solution from the 10' by 10' area.
6. Repeat step 4 until the entire floor area has been cleaned.
7. Thoroughly clean and store all equipment after use.
8. Remove wet floor signs.
9. Burnish as needed (see Resilient Floor Finishing Maintenance Guide – Page 82).

**Special Considerations – If disinfection of finished floors is required, use Hybrid finishes to prevent stickiness from quats.**

## **TERRAZZO (FINISHED) CARE: INTERIM MAINTENANCE**

See Resilient Floor Finishing Maintenance Guide – Page 83

*Special Considerations – To maintain alcohol sanitizer resistance, spray buff or maintainer products should not be used on Hybrid finishes.*

## **TERRAZZO (FINISHED) CARE: RESTORATIVE MAINTENANCE**

See Resilient Floor Finishing Maintenance Guide – Pages 84-91

*Special Considerations – Apply 2 coats of Taj Mahal Sealer/Finish or Vinyl and Stone Sealer prior to finish application. Apply only Rivet under Hybrid finishes.*

# VCT & VINYL CARE: DAILY MAINTENANCE WITH AUTOMATIC SCRUBBER AND MOP/BUCKET

## EQUIPMENT REQUIRED

Treated dust mop
Damp mop (cotton or synthetic)
Mop bucket with wringer
Auto scrubber
Red pads
Wet floor signs
Proper safety equipment (goggles, gloves and appropriate footwear)

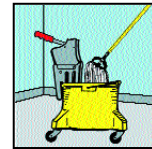
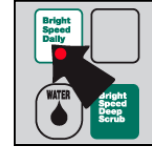
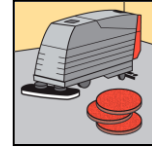

## PRODUCT REQUIRED

Product	Dilution Rate
Quik Fill 35 MAXX Dual Action Floor Cleaner	1/8-1/4 oz/gal
QC 35 MAXX Dual Action Floor Cleaner	1/4-1/2 oz/gal
Quik Fill 34 Neutral Floor Cleaner	1/2-2 oz/gal
QC 34 High Performance UC Neutral Floor Cleaner	1/4-1 oz/gal
FACILIPRO™ Alkaline Floor Cleaner	1/8-1/4 oz/gal
FACILIPRO™ Concentrated Alkaline Floor Cleaner	1/4-1/2 oz/gal
FACILIPRO™ Neutral Floor Cleaner	1/2-2 oz/gal
FACILIPRO™ Concentrated Neutral Floor Cleaner	1/4-1 oz/gal

## PROCEDURE

### Automatic Scrubber

1. Position wet floor signs. Put on proper safety equipment.
2. Use treated broom to sweep accumulated soil from the floor surface into dust pan for disposal.
3. Mix cleaning solution in the auto scrubber and mop bucket using appropriate dilution rate.
4. Position the red pad onto the auto scrubber.
5. Using the auto scrubber, apply the cleaning solution, scrub and pick up residue in one operation.
6. Mop the corners and edges manually and remove any excess solution.
7. Thoroughly clean and store all equipment and pads after use.
8. Remove wet floor signs.
9. Burnish as needed (see Resilient Floor Finishing - Maintenance Guide Page 82).

### Mop and Bucket

1. Position wet floor signs. Put on proper safety equipment.
2. Use treated broom to sweep accumulated soil from the floor surface into dust pan for disposal.
3. Mix cleaning solution in the mop bucket using appropriate dilution rate per gallon of water.
4. Use a cotton or synthetic mop with cleaning solution.
5. Partially wring out mop and apply cleaning solution to approximately 10' by 10' area of floor surface. Thoroughly wring out mop and pick up excess solution from the 10' by 10' area.
6. Repeat step 4 until the entire floor area has been cleaned.
7. Thoroughly clean and store all equipment after use.
8. Remove wet floor signs.
9. Burnish as needed (see Resilient Floor Finishing Maintenance Guide – Page 82).

**Special Considerations – If disinfection of finished floors is required, use Hybrid finishes to prevent stickiness from quats.**

## **VCT & VINYL CARE: INTERIM MAINTENANCE**

See Resilient Floor Finishing Maintenance Guide – Page 83

*Special Considerations – To maintain alcohol sanitizer resistance, spray buff or maintainer products should not be used on Hybrid finishes.*

## **VCT & VINYL CARE: RESTORATIVE MAINTENANCE**

See Resilient Floor Finishing Maintenance Guide – Pages 84-91

*Special Considerations – None.*

# WOOD FLOOR CARE: DAILY MAINTENANCE WITH DUST MOPPING

## EQUIPMENT REQUIRED

Walk off mats
Treated dust mop
Cotton Towels
Proper safety equipment (goggles, gloves and appropriate footwear)

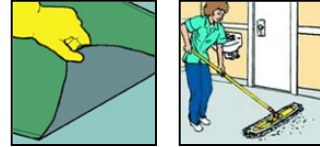

## PRODUCT REQUIRED

Product	Dilution Rate
Huntolene® Dust Mop Treatment	RTU
Full Court Wood Floor Cleaner	2-4 oz/gal

## PROCEDURE

### Dust Mopping

1. Pick up and dispose of debris. Remove gum from floor.
2. Use Huntolene® treated dust mop to sweep accumulated soil from the floor surface into dust pan for disposal.
3. Clean up spills with Full Court Wood Floor Cleaner and remove any moisture on the floor. Place "Wet Floor" signs until floor dries.
4. Vacuum floor mats.

# WOOD FLOOR CARE: INTERIM MAINTENANCE WITH DAMP MOPPING

## EQUIPMENT REQUIRED

Walk off mats
Treated dust mop
Mop and bucket with wringer
Proper safety equipment (goggles, gloves and appropriate footwear)

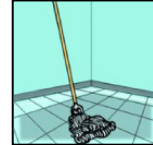

## PRODUCT REQUIRED

Product	Dilution Rate
Huntolene® Dust Mop Treatment	RTU
Full Court Wood Floor Cleaner	2-4 oz/gal

## PROCEDURE

1. Repeat daily maintenance.
2. Place "Wet Floor" signs until floor dries.
3. Damp mop the floor with Full Court Wood Floor Cleaner.

# WOOD FLOOR CARE: RESTORATIVE MAINTENANCE WITH SCREENING AND REFINISHING

## EQUIPMENT REQUIRED

Low speed swing machine
120 mesh screen or maroon pad
Wet vac or floor vac with wand
Push broom and mop bucket with wringer
White towels
T-bar (weighted for oil based finishes)
Proper safety equipment (goggles, gloves and appropriate footwear)

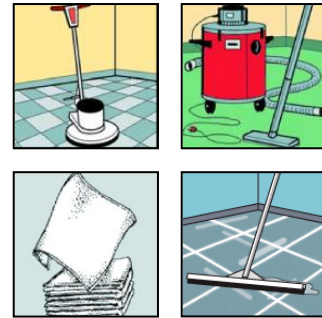

## PRODUCT REQUIRED

Product	Dilution Rate
Front Court (water based finish)	RTU
Classic 50 Ultra™ (oil based finish)	RTU

## PROCEDURE

1. Position wet floor signs. Put on proper safety equipment.
2. Place 120 mesh screen or maroon pad onto swing machine.
3. Lightly screen the floor in the direction of the boards. This should be a quick screening to rough up the surface so the next coat of finish can adhere.
4. Dry vacuum the entire floor in the direction of the boards.
5. Tack the floor – soak white towels in a mop bucket, wring them out as much as possible. Drape the damp towel over the head of a push broom and push the broom across the floor in the direction of the boards with either water or a solvent to remove fine dust. If you are going to apply a water based finish, tack with water. If you are going to use an oil based finish, tack with a solvent.
6. Repeat step 5 until all dust is removed from the floor. If any dust is removed after running your hand over the floor repeat step 5.
7. Allow floor to dry before applying finish.
8. Finish application – place synthetic head onto T-bar applicator. If applying a water based finish, use a non-weighted T-bar. If applying an oil based finish, use a weighted T-bar.
9. Pour finish onto floor in a line running with the boards down one side of the room. Using the T-bar applicator, spread the initial line of product up to the wall.
10. Starting at one end of the room, spread the product in the direction of the boards, making sure to angle the head of the applicator towards yourself so that any excess finish is pushed onto the next area to be coated. When you get to the end of the room turn the applicator towards yourself and pull excess finish onto the next area to be coated.
11. Place the applicator head on the floor and push down to remove any excess finish.
12. Repeat steps 9 – 11 until the room is coated. On the last section of floor, spread product side to side with applicator to smooth it out, and exit the room.
13. Thoroughly clean and store all equipment after use.



# RESILIENT FLOOR FINISHING MAINTENANCE GUIDE

## HIGH SPEED BURNISHING

### EQUIPMENT REQUIRED

Battery, electric or propane burnisher
Synthetic champagne pads
Hogshair or Pink eraser pads – for Hybrid finishes
Dust mop
Scraper
Damp mop
Mop bucket with wringer
Auto scrubber
Red pads
Wet floor signs
Proper safety equipment (goggles, gloves, ear plugs and appropriate footwear)

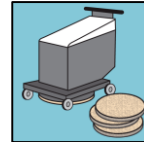

### PRODUCTS REQUIRED

Product	Dilution Rate
Quik Fill 35 MAXX Dual Action Floor Cleaner	$\frac{1}{8}$ - $\frac{1}{4}$ oz/gal
QC 35 MAXX Dual Action Floor Cleaner	$\frac{1}{4}$ - $\frac{1}{2}$ oz/gal
Quik Fill 34 Neutral Floor Cleaner	$\frac{1}{2}$ -2 oz/gal
QC 34 High Performance UC Neutral Floor Cleaner	$\frac{1}{4}$ -1 oz/gal
FACILIPRO™ Alkaline Floor Cleaner	$\frac{1}{8}$ - $\frac{1}{4}$ oz/gal
FACILIPRO™ Concentrated Alkaline Floor Cleaner	$\frac{1}{4}$ - $\frac{1}{2}$ oz/gal
FACILIPRO™ Neutral Floor Cleaner	$\frac{1}{2}$ -2 oz/gal
FACILIPRO™ Concentrated Neutral Floor Cleaner	$\frac{1}{4}$ -1 oz/gal

### PROCEDURE

1. Dust mop floor.
2. Scrape any gum, tape, or stickers from floor surface.
3. Position wet floor signs. Put on proper safety equipment.
4. Mix cleaning solution in the auto scrubber and mop bucket using appropriate dilution rate.
5. Position the **red** pad onto the auto scrubber.
6. Using the auto scrubber, apply the cleaning solution, scrub and pick up residue in one operation.
7. Mop the corners and edges manually and remove any excess solution not recovered by the auto scrubber.
8. Thoroughly clean and store all equipment and pads after use.
9. Remove wet floor signs.
10. When floor surface is dry, position **synthetic champagne** pad onto the high speed burnisher. Use **hogshair** pad for lower speed burnishers and **pink eraser** pad for propane burnishers on Hybrid finishes.
11. High speed burnish the entire floor surface with overlapping passes.
12. Check burnishing pad for soiling every 30-60 minutes of burnishing time. When the pad becomes soiled, turn it over to the clean side or change to a clean burnishing pad.
13. Thoroughly clean and store all equipment and pads after use.

**Special Considerations – To maintain alcohol sanitizer resistance, spray buff or maintainer products should not be used on Hybrid finishes.**

# SCRUB AND RECOAT

## EQUIPMENT REQUIRED

Dust mop
Black or blue detail pad
Maroon 3M Surface Prep Pad (SPP)
Scraper
Damp mop
Mop bucket with wringer
Auto scrubber or swing machine and wet vac
Blue pads
Wet floor signs and caution tape
Proper safety equipment (gloves and appropriate footwear)

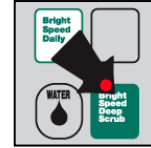
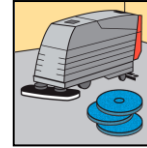

## PRODUCTS REQUIRED

Product	Dilution Rate
Quik Fill 35 MAXX Dual Action Floor Cleaner	1 oz/gal
QC 35 MAXX Dual Action Floor Cleaner	2 oz/gal
FACILIPRO™ Alkaline Floor Cleaner	1 oz/gal
FACILIPRO™ Concentrated Alkaline Floor Cleaner	2 oz/gal

## PROCEDURE

1. Dust mop floor.
2. Scrape any gum, tape, or stickers from floor surface.
3. Position wet floor signs. Put on proper safety equipment.
4. Mix cleaning solution in the auto scrubber and mop bucket using appropriate dilution rate.
5. Position the **blue** pad onto the auto scrubber or swing machine.
6. Apply the cleaning solution from the mop bucket to the corners and edges and scrub these areas with a detail pad. Apply solution to larger floor sections if using the swing machine.
7. With the swing machine, work pad across floor in overlapping sections. Remove solution with wet vac. *Go to step 10.*
8. With the auto scrubber, use the “double scrub” method.
  - e. Apply the solution with the pads down, squeegee up and the vacuum off.
  - f. Make a second pass with the pads down, squeegee down and vacuum on.
9. Use the “double scrub” method one area at a time.
10. Damp mop areas to remove wheel marks or footprints on baseboards.
11. *Alternate method – Position maroon 3M Surface Prep Pad (SPP) on machine and make one or two even passes across floor surface. May be run wet with water or dry. Clean powder from floor with fresh water solution.*
12. Allow floor surface to dry.
13. Inspect the floor to ensure that a clean, even appearance exists. All marks (scuffs, black heel marks, and scratches) should be removed. If not, repeat the scrubbing and pickup process on any area of concern.
14. Thoroughly clean and store all equipment and pads after use.
15. Remove wet floor signs.
16. **See section on floor finishing procedure.**

## GENERAL COMMENTS

Never recoat a floor that has not been cleaned by scrubbing. Damp mopping will not remove all of the soil; floor discoloration will quickly develop due to soil entrapment. Film integrity/adhesion problems may also occur.

## FLOOR STRIPPING

### EQUIPMENT REQUIRED

Stripping machine and wet vac
Black stripping pads
Black Hi-Pro Pad – for Hybrid finishes
Maroon 3M Surface Prep Pad (SPP)
Auto scrubber
Dust mop
Two damp mops
Two mop buckets
Black or blue detail pad or scraper
Floor squeegee
Towels
p-H test strips
Wet floor signs and caution tape
Proper safety equipment (goggles, gloves and appropriate footwear)

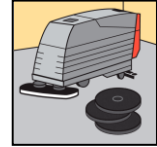

### PRODUCTS REQUIRED

Product	Dilution Rate
MAXX Floor Stripper	6-16 oz/gal – Conventional 32 oz/gal – Hybrid
Bright Blast Floor Stripper	8-21 oz/gal
Care Strip L.O.® Floor Finish Stripper	8-21 oz/gal
Heavy Duty Low Odor Floor Stripper*	14-21 oz/gal
Linoleum Floor Stripper	21-32 oz/gal
FACILIPRO MAXX Floor Stripper	6-16 oz/gal – Conventional 32 oz/gal – Hybrid
FACILIPRO Bright Blast Floor Stripper	8-21 oz/gal
FACILIPRO Carestrip LO Stripper	8-21 oz/gal
FACILIPRO HD Low Odor Stripper*	14-21 oz/gal
Prep Pak™ Neutralizer/ Conditioner	RTU
Lift Off® Baseboard Stripper	RTU

### PROCEDURE

1. Dust mop floor.
2. Position wet floor signs and mark off area with caution tape. Put on proper safety equipment.
3. Dilute floor stripper with cold water according to product label in one mop bucket.
4. Fill other mop bucket with water. Create a barrier by laying water along the edge of work area about two feet wide.
5. Apply generous amount of stripping solution with a string mop to a suitable working area (approximately 200 sq. ft.) of the floor. Cover the floor section and ensure thorough wetting. Avoid splashing stripping solution on areas not requiring stripping.
6. Allow solution to work for approximately 10 minutes (Allow to work 30 minutes to remove MAXX / FACILIPRO Durable Floor Finish – use MAXX Floor Finish Remover/ FACILIPRO Premium Low Odor Stripper at 32 oz/gal). Do not allow the floor to dry.

7. Position **black** stripping pad onto stripping equipment. **Use Hi-Pro pad when stripping Hybrid finishes.** Not applicable for use with a propane stripping machine. Scrub until all of the finish has been loosened from the floor. Pick up dissolved finish with a stripping machine or wet dry vacuum.
8. Use a detail pad or a scraper along the baseboards or edges to remove any excess finish.
9. Observe the floor for signs of incomplete finish removal. Pay particular attention to areas along baseboards or edges. If necessary repeat steps 3-8 until all of finish has been removed.
10. Rinse the floor with an auto scrubber and clean water or with a mop, bucket, and clean water. Clean any splashed stripping solution off baseboards or edges.
11. Rinse repeatedly until the floor reaches a pH of 7-8.
12. Repeat steps 3-11 until each section of the floor has been stripped and rinsed.
13. *Alternate method – Position maroon 3M Surface Prep Pad on machine and make 3-4 even passes across floor surface. May be run wet with water or dry. Clean powder from floor with fresh water solution.*
14. Allow the floor to dry completely before applying finish.
15. **See section on floor finishing procedure.**
16. Thoroughly clean and store all equipment after use.
17. Remove wet floor signs and caution tape.

**\* Special Considerations: For a full sustainable offering, use Heavy Duty Low Odor Floor Stripper with Ecolab's Low Maintenance Floor Finish.**

**MAXX Floor Finish Remover/ FACILIPRO MAXX Floor Stripper is to be used in conjunction with MAXX/ FACILIPRO Durable Floor Finish. It can also be used with other Ecolab Floor Finishes.**

**Stripping by non-chemical means (SPP) does not remove all residual finish from the floor. To ensure hand sanitizer resistance, a full chemical strip should be done prior to applying Hybrid finishes.**

## CONVENTIONAL FLOOR FINISHING

### EQUIPMENT REQUIRED

Floor finish mop (rayon or blend)
Mop bucket and wringer
Plastic trash liner
Wet floor signs and caution tape
Proper safety equipment (gloves and appropriate footwear)

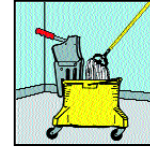

### PRODUCTS REQUIRED

Product	Dilution Rate	Product	Dilution Rate
Low Maintenance Floor Finish*	RTU	FACILIPRO Low Maint. Floor Finish*	RTU
MonoStar® Floor Finish	RTU	FACILLIPRO Monostar® Floor Finish	RTU
Laser Floor Finish	RTU	FACILIPRO Laser	RTU
Stratus Floor Finish	RTU	FACILIPRO Stratus	RTU
Taj Mahal Sealer Finish	RTU	FACILIPRO Taj Mahal Sealer Finish	RTU
Polaris Floor Finish	RTU		
		FACILIPRO Gemini Pro	RTU

### PROCEDURE

1. Prepare the floor surface using stripping or scrub and recoat procedures.
2. Position wet floor signs. Mark off the area with caution tape. Put on safety equipment.
3. Use only clean finish mops for application of finish.
4. Line the bucket with a plastic trash liner and carefully pour the floor finish into the bucket. Avoid over agitation that could cause foaming.
5. Saturate the mop head in the bucket with the floor finish. Place the mop in the wringer and tightly wring out the mop head. Repeat this procedure two more times.
6. Note that a properly wetted mop will only drip a few times when removed from the wringer. A constant flow of drips will make the finish apply too heavy, which can negatively impact dry time and gloss.
7. Apply finish in the section farthest away from the door or wherever you need to exit.
8. If applying more than one coat, keep 12 inches away from the baseboards or edges on the first coat to avoid build-up. Gradually work in on additional coats. Avoid getting finish onto the baseboard or edges.
9. Outline the section to be covered with the mop on the first pass.
10. Fill in the section by swinging mop in a figure eight pattern, allowing mop to go onto but not over outlines.
11. Watch for missed spots (referred to as “holidays”). If a missed spot is found within three minutes, swing the mop over the missed area and continue.
12. Periodically flip mop over for a more even finish application. Usually every four feet.
13. When outlined section has been filled in or when mop shows signs of drying (usually 20-24 feet as you move backwards) saturate mop again in finish and wring out mop head. Refer back to step 6. Outline next section and fill in.
14. Repeat steps 9-11 until entire floor has been coated.
15. Continue applying additional coats of finish, until the desired number of coats is applied. Note that no more than 4 coats of MonoStar should be applied in any 24 hour period. Make sure floor is completely dry between coats.
16. Average dry time to walk on floor will be 30-40 minutes. Dry time will vary based on thickness of coat, temperature, humidity, and ventilation.
17. Thoroughly clean and store all equipment after use.

**\* Special Considerations: For a full sustainable offering, strip Low Maintenance Floor Finish with Heavy Duty Low Odor Floor Stripper.**

# PHAZER FLOOR FINISHING

## EQUIPMENT REQUIRED

Phazer® backpack and applicator
White applicator pad
White towel
Plastic bag
Wet floor signs and caution tape
Proper safety equipment (gloves and appropriate footwear)

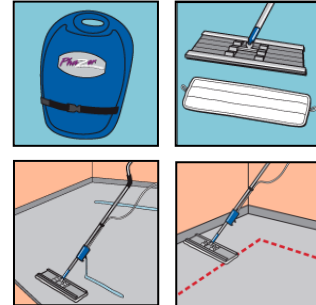

## PRODUCTS REQUIRED

Product		Product	
Low Maintenance Floor Finish- Phazer® *	RTU	FACILIPRO Low Maintenance – Phazer	RTU
MonoStar® - Phazer®	RTU	FACILIPRO MonoStar – Phazer	RTU
Laser – Phazer®	RTU	FACILIPRO Laser – Phazer	RTU
Stratus – Phazer®	RTU	FACILIPRO Stratus – Phazer	RTU
Taj Mahal- Phazer®	RTU	FACILIPRO Taj Mahal – Phazer	RTU
Polaris - Phazer®	RTU		

## PROCEDURE

1. Prepare the floor surface using stripping or scrub and recoat procedures.
2. Position wet floor signs. Mark off the area with caution tape. Put on safety equipment.
3. Put white pad onto the Phazer applicator head.
4. Place the bag of product into the Phazer backpack with the spout at the bottom of the backpack facing out and slide the spout into the locked position. Remove the dust cap.
5. Attach the delivery tube to the spout and hand tighten until it locks. Close the cover and secure the locking strap.
6. Put on the backpack. Adjust the straps so the weight of the backpack is on your hips rather than on your shoulders.
7. Place a clean, white, damp towel in your pocket for wiping up any spills.
8. Start by working the applicator pad through a puddle of product to pre-load the pad. This step is only necessary if you are using a fresh, rinsed pad.
9. Outline a 6-8 foot section using the widest part of the pad. Apply a bead of product 18-20 inches from the edge of the section.
10. Fill in the 6-8 foot section using an overlapping figure eight pattern so that the pad pulls the bead of product into the section.
11. When outlined section has been filled in or when mop shows signs of drying, saturate again with the floor finish by squeezing the trigger on the Phazer handle.
12. Repeat steps 10 and 11 until entire floor has been coated. Place the Phazer applicator head in a plastic bag.
13. Average dry time to walk on floor will be 30-40 minutes. Dry time will vary based on coat thickness, temperature, humidity, and air flow. Allow ~ 45 minutes between coats.
14. Continue applying additional coats of finish, until the desired number of coats is applied. Note that no more than 4 coats of MonoStar should be applied in any 24 hour period. Make sure floor is completely dry between coats. Place the Phazer applicator head in a plastic bag between coats.
15. Thoroughly clean and store all equipment after use.
16. Remove wet floor signs and caution tape.

**\*Special Considerations: For a full sustainable offering, strip with Ecolab’s Heavy Duty Low Odor Stripper.**

# HYBRID FLOOR FINISHING

## EQUIPMENT REQUIRED

Floor finish mop (rayon or blend)
Mop bucket and wringer
Plastic trash liner
Wet floor signs and caution tape
Proper safety equipment (gloves and appropriate footwear)

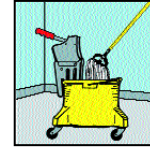

## PRODUCTS REQUIRED

Product	Dilution
MAXX Durable Floor Finish Kit (Part A & B)	RTU

## PROCEDURE

### String Mop Application

1. Prepare the floor surface using stripping or scrub and recoat procedures. **See sections on floor stripping or scrub and recoat procedures.**
2. Plan your route. Position wet floor signs and mark off the area with caution tape. Put on proper safety equipment.
3. Use only new finish mops for application of finish.
4. Remove cover from 1 gallon bottle of MAXX Durable Floor Finish Part A.
5. Remove cover from 8 oz can of MAXX Durable Floor Finish Part B and pour contents into Part A until can no longer drips.
6. Recap Part A container and shake vigorously for 1 -2 minutes.
7. Allow product to rest for 10 minutes to reduce bubbles formed during shaking.
8. Fill Part B can with water, recap and dispose of under regular chemical container guidelines.
9. Line the mop bucket with a plastic trash liner and carefully pour the floor finish into the bucket. Avoid over agitation that could cause foaming.
10. Saturate the mop head in the bucket with the floor finish. Place the saturated mop head in the wringer and tightly wring out the mop head. Repeat this procedure two more times.
11. Note that a properly wetted mop will only drip a few times when removed from the wringer. A constant flow of drips will make the finish apply too heavy, which can negatively impact dry time and gloss.
12. Start by applying finish in the section farthest away from the door or exit.
13. If applying more than one coat, keep 12 inches away from the baseboards or edges on the first coat to avoid build-up. Gradually work in on additional coats. Avoid getting finish onto the baseboard or edges.
14. Outline the section to be covered with the mop on the first pass.
15. Fill in the section by swinging mop in a figure eight pattern, allowing mop to go onto but not over outlines.
16. Watch for missed spots (referred to as "holidays"). If a missed spot is found within three minutes, swing the mop over the missed area and continue.
17. Periodically flip mop over for a more even finish application. Usually every four feet as you move backwards.
18. When outlined section has been filled in or when mop shows signs of drying (usually 20-24 feet as you move backwards) saturate mop again in finish and wring out mop head. Refer back to step 6. Outline next section and fill in.
19. Repeat steps 9-11 until entire floor has been coated.



20. Continue applying additional coats of finish, until the desired number of coats is applied. Make sure floor is completely dry between coats.
21. Average dry time to walk on floor will be 20-25 minutes. Dry time will vary based on thickness of coat, temperature, humidity and ventilation.
22. Thoroughly clean and store all equipment after use.
23. Remove wet floor signs and caution tape.

## Flat Mop Application

1. Follow instructions for floor and product prep (see steps 1-8 above)
2. Attach new microfiber pad to applicator stick.
3. Remove cap from bottle and apply a puddle of product to the floor.
4. Start by working the applicator pad through a puddle of product to pre-load the pad. This step is only necessary if you are using a fresh, rinsed pad.
5. Outline a 6-8 foot section using the widest part of the pad. Using the product bottle, apply a bead of product 18-20 inches from the edge of the section.
6. Fill in the 6-8 foot section using an overlapping figure eight pattern so that the pad pulls the bead of product into the section.
7. When outlined section has been filled in or when mop shows signs of drying, saturate again with the floor finish by pouring more product from the bottle.
8. Repeat steps 10 and 11 until entire floor has been coated. Place the flat mop head in a plastic bag.
9. Average dry time to walk on floor will be 20-25 minutes. Dry time will vary based on thickness of coat, temperature, humidity, and air flow.
10. Continue applying additional coats of finish, until the desired number of coats is applied. Make sure floor is completely dry between coats. Place the flat mop head in a plastic bag between coats.
11. Thoroughly clean and store all equipment after use.
12. Remove wet floor signs and caution tape.

***Special Considerations: MAXX Floor Stripper/ FACILIPRO MAXX Floor Stripper to be used in conjunction with MAXX/ FACILIPRO Durable Floor Finish. If a sealer is required, apply only Rivet under Hybrid finishes.***

***POT LIFE = 6-8 hours***



# PHAZER HYBRID FLOOR FINISHING

## EQUIPMENT REQUIRED

Phazer® backpack and applicator
White applicator pad
White towel
Plastic bag
Wet floor signs and caution tape
Proper safety equipment (gloves and appropriate footwear)

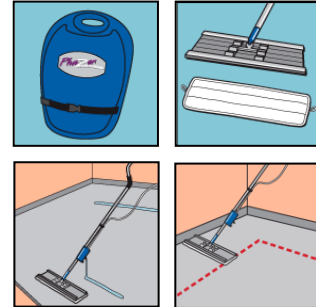

## PRODUCTS REQUIRED

Product	Size
MAXX Durable Floor Finish Kit Phazer® (Part A & B)	RTU
FACILIPRO™ MAXX Durable Floor Finish Kit Phazer® (Part A & B)	RTU
MAXX Matte Durable Floor Finish Kit Phazer® (Part A & B)	RTU

## PROCEDURE

1. Prepare the floor surface using stripping or scrub and recoat procedures. **See sections on floor stripping or scrub and recoat procedures..**
2. Plan your route. Position wet floor signs and mark off the area with caution tape. Put on proper safety equipment.
3. Put white pad onto the Phazer® applicator head.
4. Place the bag of MAXX Durable Phazer Floor Finish Part A product into the Phazer® backpack with the red bag spout at the bottom of the backpack facing out.
5. Slide the spout into the locked position. Remove the red cap.
6. Remove cover from 8 oz can of Durable Floor Finish Part B and pour contents into Part A until can no longer drips.
7. Re-cover Part A bag, remove from backpack and mix vigorously for 1-2 minutes by alternately lifting each end up and down.
8. Place the bag of mixed product back into the Phazer® backpack with the pink bag spout at the bottom of the backpack facing out. Allow product to rest for 10 minutes to reduce bubbles formed from shaking.
9. Fill Part B can with water, recap and dispose of under regular chemical container guidelines.
10. Remove the dust cap from the pink spout.
11. Attach the delivery tube to the spout and tighten until it locks. Close the cover and secure the locking strap.
12. Put on the backpack. Adjust the straps so the weight of the backpack is on your hips rather than on your shoulders.
13. Place a clean, white, damp towel in your pocket for wiping up any spills or misapplications. Also carry a plastic bag that you will use to cover the applicator pad after application.
14. Start by working the applicator pad through a puddle of product to pre-load the pad. This step is only necessary if you are using a fresh, rinsed pad.
15. Outline a 6-8 foot section using the widest part of the pad. Apply a bead of product 18-20 inches from the edge of the section.

16. Fill in the 6-8 foot section using an overlapping figure eight pattern so that the pad pulls the bead of product into the section.
17. When outlined section has been filled in or when mop shows signs of drying, saturate again with the floor finish by squeezing the trigger on the Phazer® handle.
18. Repeat steps 10 and 11 until entire floor has been coated. Place the Phazer® applicator head in a plastic bag.
19. Average dry time to walk on floor will be 20-25 minutes. Dry time will vary based on thickness of coat, temperature, humidity, and air flow.
20. Continue applying additional coats of finish, until the desired number of coats is applied. Make sure floor is completely dry between coats. Place the Phazer® applicator head in a plastic bag between coats.
21. Thoroughly clean and store all equipment after use.
22. Remove wet floor signs and caution tape.

***Special Considerations: MAXX / FACILIPRO Floor Stripper to be used in conjunction with MAXX/ FACILIPRO MAXX Durable Floor Finish - Phazer®. If a sealer is required, apply only Rivet under Hybrid finishes.***

***POT LIFE = 6-8 hours***

# FLOOR AND CHEMICAL COMPATIBILITY CHART

	Dilution (oz/gal)	Bamboo	Carpet (nylon)	Ceramic	Cork	Engineered Stone (Agglomerate)	Granite	Laminate	Limestone	Linoleum	Luxury Vinyl	Marble	Quarry	Recycled Rubber	Rubber	State	Sport Floor	Terrazzo - Cement	Terrazzo - Epoxy	Travertine	VCT/Sheet Vinyl	Vinyl (Kitchen)	Wood
<b>Neutral</b>																							
QF/QC 34 Neutral FC	0.25	√	-	√	√	√	√	√	√	√	√	√	√	√	NT	√	√	√	√	√	√	√	√
or Oasis 100	2	√	-	√	√	√	√	√	√	√	√	√	√	√	√	√	√	√	√	√	√	√	√
Wash 'N Walk	6	√	-	√	√	√	√	√	√	√	√	√	√	√	NT	√	√	√	√	√	√	√	√
	2	√	-	√	√	√	√	√	√	√	√	√	√	√	√	√	√	√	√	√	√	√	√
<b>Alkaline</b>																							
QF/QC 35 MAXX Dual Action Cleaner	0.25	√	-	√	√	√	√	√	√	√	√	√	√	√	NT	√	√	√	√	√	√	√	√
	1	√	-	√	√	√	√	√	√	√	√	√	√	√	√	√	√	√	√	√	√	√	√
	3	√	-	√	√	√	√	√	√	√	√	√	√	√	NT	√	√	√	√	√	√	√	√
Pinnacle Intensive Tile	12	√	x	√	√	√	√	√	√	√	√	√	√	√	NT	√	√	√	√	√	√	√	√
	64	√	x	√	√	√	√	√	√	√	√	√	√	√	NT	√	√	√	√	√	√	√	√
Oasis 115XP	1	√	-	√	√	√	√	√	√	√	√	√	√	√	NT	√	√	√	√	√	√	√	√
	2	√	-	√	√	√	√	√	√	√	√	√	√	√	√	√	√	√	√	√	√	√	√
Titan	4	√	-	√	√	√	√	√	√	√	√	√	√	√	√	√	√	√	√	√	√	√	√
Kay 2 in 1	0.75	√	-	√	√	√	√	√	√	√	√	√	√	√	√	√	√	√	√	√	√	√	√
Enforce	1	√	-	√	√	√	√	√	√	√	√	√	√	√	NT	√	√	√	√	√	√	√	√
	2	√	-	√	√	√	√	√	√	√	√	√	√	√	√	√	√	√	√	√	√	√	√
<b>Disinfectants</b>																							
20 Neutral Disinfectant	0.5	√	-	√	√	√	√	√	√	√	√	√	√	√	NT	√	√	√	√	√	√	√	√
	1	√	-	√	√	√	√	√	√	√	√	√	√	√	√	√	√	√	√	√	√	√	√
A-456 II Disinfectant	0.5	√	-	√	√	√	√	√	√	√	√	√	√	√	√	√	√	√	√	√	√	√	√
Disinfectant 2.0	2	√	-	√	√	√	√	√	√	√	√	√	√	√	√	√	√	√	√	√	√	√	√
<b>Acid</b>																							
Prep Pak	1:3gal	√	-	√	√	√	√	√	√	√	√	√	√	√	NT	√	√	√	√	√	√	√	√
Oasis 125XP	1	√	√	√	√	√	√	√	√	√	√	√	√	√	NT	√	√	√	√	√	√	√	√
	2	√	√	√	√	√	√	√	√	√	√	√	√	√	√	√	√	√	√	√	√	√	√

NT = not tested

- = not designed for use on carpet, use care in transition areas

X = will damage backing

\*These are general compatibility guidelines. Always test products in an inconspicuous area on specific surfaces before cleaning.